

# CMI-CDP3020NF-SERIES



## Features

- ▶ High current and low profile.
- ▶ Available tape and reel for auto insertion
- ▶ Simple and Shield structure.

## Applications

- ▶ Equipment using for automotive  
(ECM, airbags, headlights, electronic powder steering, motors, ABS, other)



Dimension (Unit:mm)

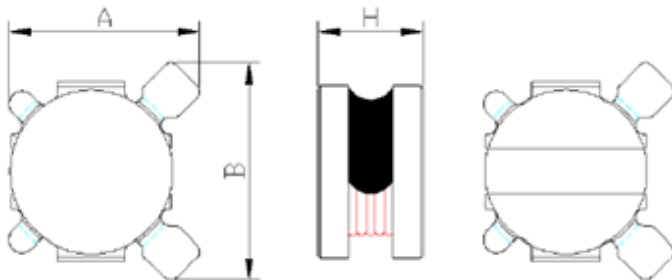

A	B	H
3.5 Max	3.8 Max	2.0Max

Land Pattern (Unit:mm)

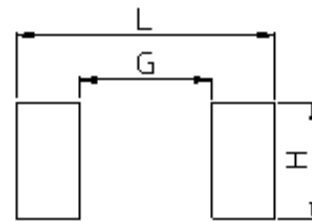

L	G	H
3.4	1.8	2.7

## Specifications

Part Number	Inductance (uH) ±20%	DCR(mohm) Max.(Typ.)	IDC1(A) Max.(Typ.)	IDC2(A) Max.(Typ.)	Test Frequency (Hz)
CMI-CDP3020NF-3R3M	3.3	110(90)	1.60(1.70)	1.50(2.00)	100k

- IDC1: When based on the inductance change rate (approximately 30% below in the initial value)
- IDC2: When based on the temperature increase (Temperature increase of approximately 40°C by self heating)
- Operating Temperature Range(including self temperature) : -40°C ~ +165 °C

Ilsan Sales Office (KOREA)

+82)31-904-1444

[coilmaster@coilmaster.com](mailto:coilmaster@coilmaster.com)

H.K Sales Office (HONGKONG)

+852)2711-5551

[coilmaster@coilmaster.com](mailto:coilmaster@coilmaster.com)

Shenzhen Sales Office (CHINA)

+86)755-8663-6929

[coilmaster@coilmaster.com](mailto:coilmaster@coilmaster.com)

LA Sales Office (USA)

+1)866-446-3586

[coilmaster@coilmaster.com](mailto:coilmaster@coilmaster.com)

Hungary Sales office (EUROPE)

+36)30-913-7706

[coilmaster@coilmaster.com](mailto:coilmaster@coilmaster.com)

- All specifications are subject to change without notice.
- Update date : 2015.11.18

[www.coilmaster.com](http://www.coilmaster.com)