

# CMI-CDP4020NF-SERIES



## Features

- ▶ High current and low profile.
- ▶ Available tape and reel for auto insertion
- ▶ Simple and Shield structure.

## Applications

- ▶ Equipment using for automotive  
(ECM, airbags, headlights, electronic powder steering, motors, ABS, other)



Dimension (Unit:mm)

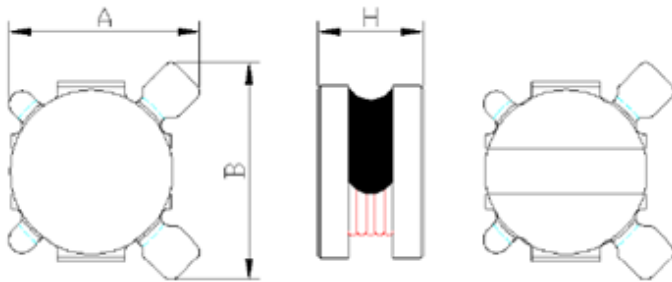

A	B	H
4.0±0.3	4.0±0.3	2.0Max

Land Pattern (Unit:mm)

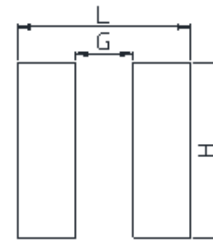

L	G	H
4.6	2.1	4.2

## Specifications

Part Number	Inductance (uH) ±20%	DCR(mohm) Max.(Typ.)	IDC1(A) Max.(Typ.)	IDC2(A) Max.(Typ.)	Test Frequency (Hz)
CMI-CDP4020NF-1R0M	1.0	30(25)	4.30(4.80)	3.20(3.60)	100k
CMI-CDP4020NF-2R2M	2.2	48(40)	3.10(3.40)	2.50(2.80)	100K
CMI-CDP4020NF-4R7M	4.7	96(80)	2.80(3.00)	2.40(2.60)	100k
CMI-CDP4020NF-6R8M	6.8	168(140)	2.40(2.60)	2.00(2.20)	100k
CMI-CDP4020NF-100M	10	216(180)	1.80(1.90)	1.50(1.60)	100K

- IDC1: When based on the inductance change rate (approximately 30% below in the initial value)
- IDC2: When based on the temperature increase (Temperature increase of approximately 40°C by self heating)
- Operating Temperature Range(including self temperature) : -40°C ~ +165 °c

Ilisan Sales Office (KOREA)  
H.K Sales Office (HONGKONG)  
Shenzhen Sales Office (CHINA)  
LA Sales Office (USA)  
Hungary Sales office (EUROPE)

+82)31-904-1444  
+852)2711-5551  
+86)755-8663-6929  
+1)866-446-3586  
+36)30-913-7706

[coilmaster@coilmaster.com](mailto:coilmaster@coilmaster.com)  
[coilmaster@coilmaster.com](mailto:coilmaster@coilmaster.com)  
[coilmaster@coilmaster.com](mailto:coilmaster@coilmaster.com)  
[coilmaster@coilmaster.com](mailto:coilmaster@coilmaster.com)  
[coilmaster@coilmaster.com](mailto:coilmaster@coilmaster.com)

- All specifications are subject to change without notice.
- Update date : 2016.12.05