

# CMI-CDSS6045NH-SERIES

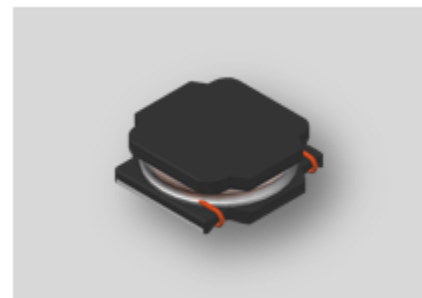

## Features

- ▶ High current and low profile.
- ▶ Available tape and reel for auto insertion
- ▶ Simple and Shield structure.
- ▶ RoHS compliant
- ▶ AEC-Q200 qualified.
- ▶ Halogen-Free



## Applications

- ▶ Car navigation, car stereo and car accessories only  
(Not available for use related to driving, curving, stopping, and the other safety.)

### Dimension (Unit:mm)

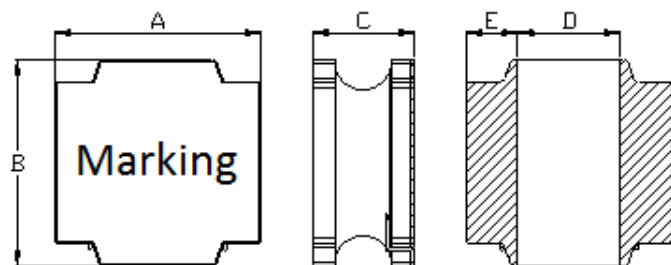

A	B	C	D	E
6.0±0.3	6.0±0.3	4.7 Max.	1.7±0.3	2.6±0.3

### Land Pattern (Unit:mm)

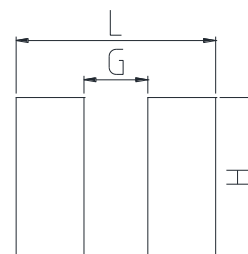

L	G	H
6.0	2.4	5.7

## Specifications

Part Number	Inductance (uH)	Tolerance (±)	DCR(mΩ) ±20%	IDC1(A) Max.	IDC2(A) Max.	Test Frequency (Hz)
CMI-CDSS6045NH-1R0N	1.0	30%	11	9.85	5.14	100k
CMI-CDSS6045NH-1R2N	1.2	30%	12	9.40	5.05	100k
CMI-CDSS6045NH-1R5N	1.5	30%	12	8.80	4.95	100k
CMI-CDSS6045NH-1R8N	1.8	30%	13	8.00	4.80	100k
CMI-CDSS6045NH-2R2N	2.2	30%	14	6.75	4.60	100k
CMI-CDSS6045NH-3R3N	3.3	30%	21	5.90	3.70	100k
CMI-CDSS6045NH-4R7M	4.7	20%	26	4.97	3.30	100k
CMI-CDSS6045NH-5R6M	5.6	20%	29	4.15	3.15	100k
CMI-CDSS6045NH-6R8M	6.8	20%	31	3.90	3.00	100k
CMI-CDSS6045NH-8R2M	8.2	20%	43	3.90	2.60	100k
CMI-CDSS6045NH-100M	10	20%	48	3.20	2.45	100k
CMI-CDSS6045NH-150M	15	20%	68	2.50	2.05	100k
CMI-CDSS6045NH-220M	22	20%	89	2.05	1.80	100k

• You can also contact us by e-mail : [coilmaster@coilmaster.com](mailto:coilmaster@coilmaster.com)

- All specifications are subject to change without notice.
- Update date : 2018.04.11

Part Number	Inductance (uH)	Tolerance (±)	DCR(mΩ) ±20%	IDC1(A) Max.	IDC2(A) Max.	Test Frequency (Hz)
CMI-CDSS6045NH-330M	33	20%	137	1.65	1.45	100k
CMI-CDSS6045NH-470M	47	20%	200	1.40	1.20	100k
CMI-CDSS6045NH-560M	56	20%	221	1.30	1.10	100k
CMI-CDSS6045NH-680M	68	20%	289	1.20	1.00	100k
CMI-CDSS6045NH-101M	100	20%	433	0.95	0.80	100k
CMI-CDSS6045NH-121M	120	20%	484	0.85	0.77	100k
CMI-CDSS6045NH-151M	150	20%	580	0.80	0.70	100k
CMI-CDSS6045NH-221M	220	20%	834	0.70	0.59	100k
CMI-CDSS6045NH-331M	330	20%	1270	0.57	0.57	100k
CMI-CDSS6045NH-471M	470	20%	1800	0.50	0.42	100k
CMI-CDSS6045NH-681M	680	20%	2500	0.42	0.33	100k
CMI-CDSS6045NH-102M	1000	20%	4500	0.30	0.30	100k
CMI-CDSS6045NH-152M	1500	20%	6500	0.24	0.21	100k

- IDC1: When based on the inductance change rate (approximately 30% below in the initial value)
- IDC2: When based on the temperature increase (Temperature increase of approximately 40°C by self heating)
- Operating Temperature Range(including self temperature) : -40°C ~ +105 °C

Ilsan Sales Office (KOREA) +82)31-904-1444  
 Shenzhen Sales Office (CHINA) +86)755-8663-6929  
 Hungary Sales office (EUROPE) +36)30-913-7706

H.K Sales Office (HONGKONG) +852)2711-5551  
 LA Sales Office (USA) +1)866-446-3586

▪ You can also contact us by e-mail : [coilmaster@coilmaster.com](mailto:coilmaster@coilmaster.com)

- All specifications are subject to change without notice.
- Update date : 2018.04.11

[www.coilmaster.com](http://www.coilmaster.com)