

# CMI-CMMPP252010MH-SERIES



## Features

- ▶ Small size, high current and low profile.
- ▶ Metal powder molding type for EMC protection.
- ▶ Lower DCR with applying flat wire.
- ▶ Available tape and reel for auto insertion.
- ▶ Halogen-Free
- ▶ RoHS compliant.
- ▶ AEC-Q200 qualified.



## Applications

- ▶ Equipment using for automobiles (ECM, airbags, headlights, electronic Powder steering, motors, ABS, other)

Dimension (Unit:mm)

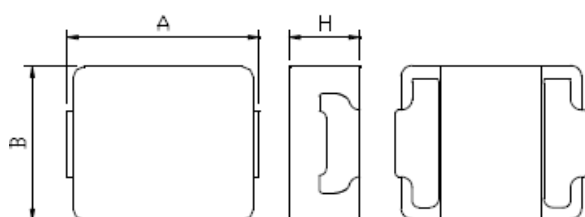

| A       | B       | H      |
|---------|---------|--------|
| 2.5±0.2 | 2.0±0.2 | 1.0Max |

Land Pattern (Unit:mm)

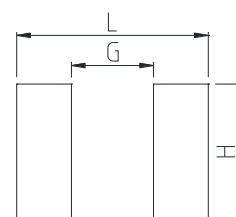

| L    | G    | H    |
|------|------|------|
| 2.80 | 1.20 | 2.00 |

## Specifications

| Part Number            | Inductance (uH) ±20% | DCR(mohm) Max(Typ) | IDC1(A) Max(Typ) | IDC2(A) Max(Typ) | Test Frequency (Hz) |
|------------------------|----------------------|--------------------|------------------|------------------|---------------------|
| CMI-CMMPP252010MH-R24M | 0.24                 | 18.2(14.0)         | 8.50(9.00)       | 5.50(6.00)       | 1M                  |
| CMI-CMMPP252010MH-R33M | 0.33                 | 23.4(18.0)         | 6.40(6.90)       | 4.80(5.30)       | 1M                  |
| CMI-CMMPP252010MH-R47M | 0.47                 | 33.8(26.0)         | 5.20(5.70)       | 3.60(3.90)       | 1M                  |
| CMI-CMMPP252010MH-R68M | 0.68                 | 44.2(34.0)         | 4.30(4.80)       | 3.20(3.60)       | 1M                  |
| CMI-CMMPP252010MH-1R0M | 1.0                  | 60.0(50.0)         | 3.80(4.30)       | 2.80(3.10)       | 1M                  |
| CMI-CMMPP252010MH-1R5M | 1.5                  | 96.0(80.0)         | 2.80(3.10)       | 2.00(2.30)       | 1M                  |
| CMI-CMMPP252010MH-2R2M | 2.2                  | 132.0(110.0)       | 2.20(2.40)       | 2.20(2.50)       | 1M                  |
| CMI-CMMPP252010MH-3R3M | 3.3                  | 192.0(160.0)       | 1.90(2.10)       | 1.60(1.80)       | 1M                  |
| CMI-CMMPP252010MH-4R7M | 4.7                  | 300.0(240.0)       | 1.60(1.80)       | 1.20(1.40)       | 1M                  |
| CMI-CMMPP252010MH-6R8M | 6.8                  | 390.0(325.0)       | 1.30(1.50)       | 1.00(1.20)       | 1M                  |

- IDC1: When based on the inductance change rate (approximately 30% below in the initial value)
- IDC2: When based on the temperature increase (Temperature increase of approximately 40°C by self heating)
- Operating Temperature Range(including self temperature) : -40°C ~ +165 °C

Ilsan Sales Office (KOREA) +82)31-904-1444  
 Shenzhen Sales Office (CHINA) +86)755-8663-6929  
 Hungary Sales office (EUROPE) +36)30-913-7706

H.K Sales Office (HONGKONG) +852)2711-5551  
 LA Sales Office (USA) +1)866-446-3586

• You can also contact us by e-mail : [coilmaster@coilmaster.com](mailto:coilmaster@coilmaster.com)

- All specifications are subject to change without notice.
- Update date : 2018.10.25

[www.coilmaster.com](http://www.coilmaster.com)