

CME-CPCF2612PN-SERIES

Common mode filter for Power line

Features

- ▶ Due to the low profile design, it is suitable for surface mount.
- ▶ Custom options for inductance, impedance, DCR and current rating are available.
- ▶ Have achieved miniaturization while keeping characteristics by adoption of exclusive square type closed magnetic cores.

Applications

- ▶ High current and high temperature applications
- ▶ EMI Filters
- ▶ Motor noise suppression.

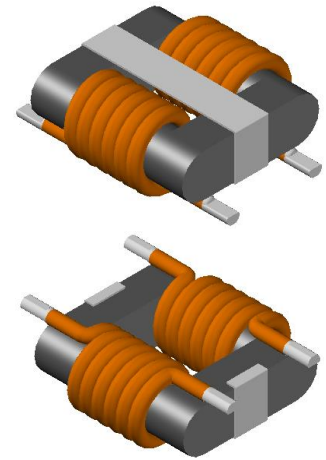

Dimension (Unit:mm)

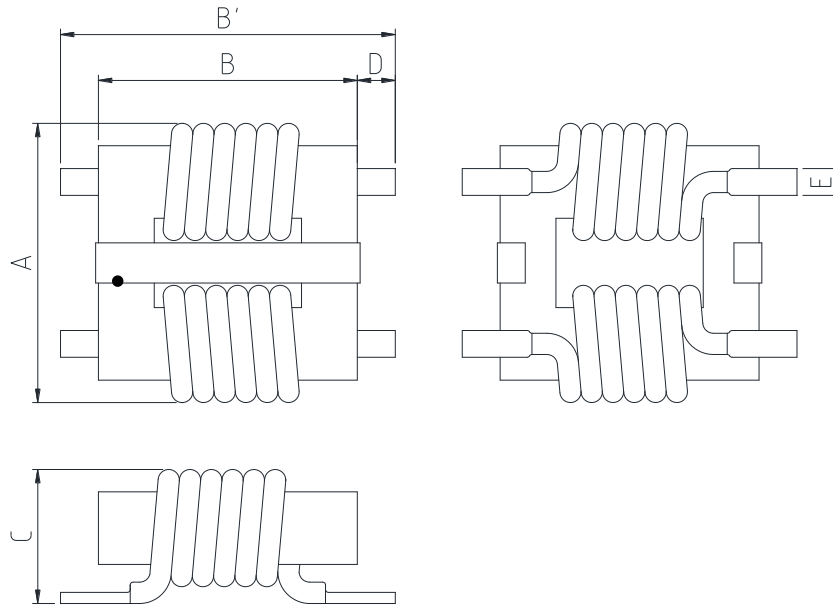

Part Number	A	B	B'	C	D	E
CME-CPCF2612PN-900M	25.5 Max.	24.5 Max.	30.5 Max.	12.0 Max.	3.4 ±0.3	2.4 ±0.2
CME-CPCF2612PN-121M	25.5 Max.	24.5 Max.	30.5 Max.	11.0 Max.	3.4 ±0.3	2.2 ±0.2
CME-CPCF2612PN-251M	24.5 Max.	24.5 Max.	30.5 Max.	10.5 Max.	3.4 ±0.3	1.8 ±0.2
CME-CPCF2612PN-301M	24.0 Max.	24.5 Max.	30.5 Max.	10.5 Max.	3.4 ±0.3	1.6 ±0.2
CME-CPCF2612PN-481M	23.5 Max.	24.5 Max.	30.5 Max.	9.5 Max.	3.4 ±0.3	1.5 ±0.2

• All specifications are subject to change without notice.
 • Update date : 2022.03.29

Recommended Land Pattern

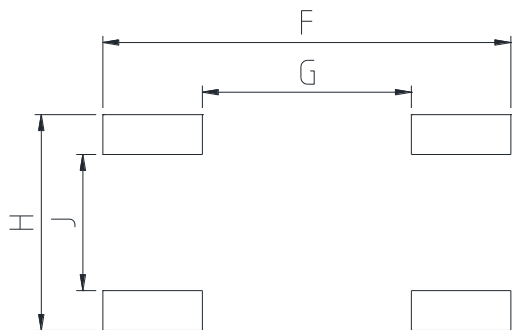

F	G	H	J
30.75	15.75	16.25	10.25

Circuit Diagram

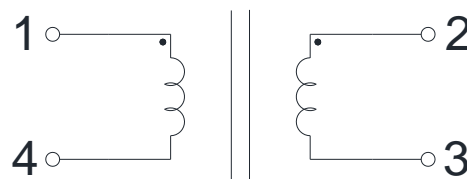

Specifications

Part Number	Inductance (uH) $\pm 30\%$	Common Mode Impedance (mohm) Typ.		DCR (ohm) Max.	Isat (A) Typ.	I _{rms} (A) Typ.	Leakage (uH) Max.
		@ 1 MHz	@ 10 MHz				
CME-CPCF2612PN-900M	90	560	380	0.0015	35.00	31.00	2.5
CME-CPCF2612PN-121M	120	790	480	0.0018	28.00	25.00	3.5
CME-CPCF2612PN-251M	250	1700	850	0.0050	19.00	14.00	7.5
CME-CPCF2612PN-481M	480	3400	1200	0.0125	13.00	8.00	14.0

- Inductance test Frequency : 100 kHz
- Isat : When based on the inductance change rate (approximately 30% below in the initial value)
- I_{rms} : When based on the temperature increase (Temperature increase of approximately 40°C by self heating)
- Operating Temperature Range(including self temperature) : -40°C ~ +155 °C

Note 1 : Circuit design, component placement, PCB trace size and thickness, airflow and other cooling. Provision all affect the part Temperature. Part temperature should be verified in the end application.

Electrical characteristics

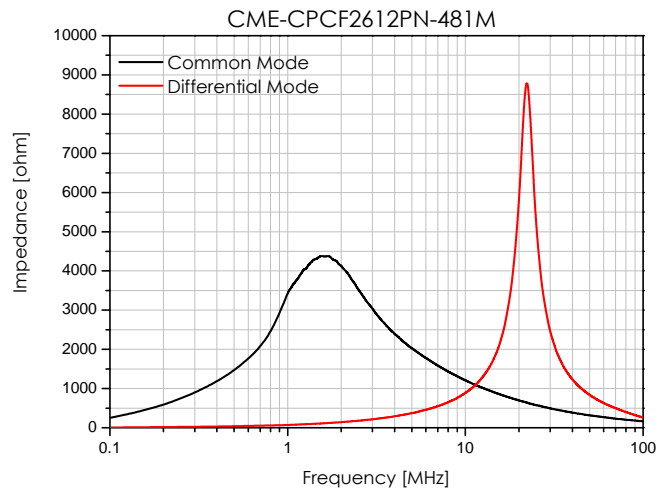
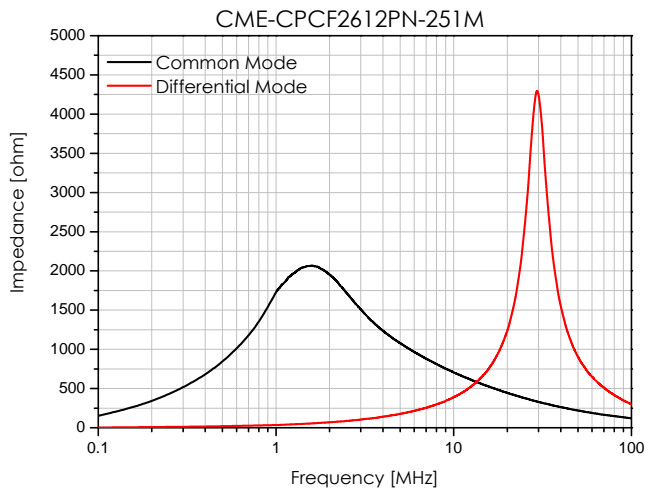
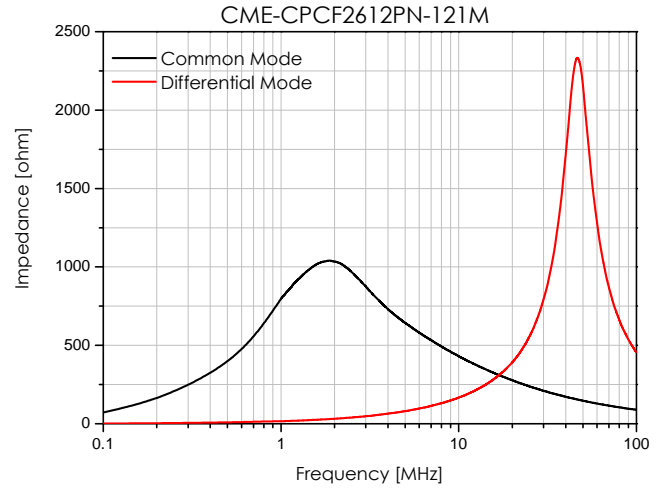
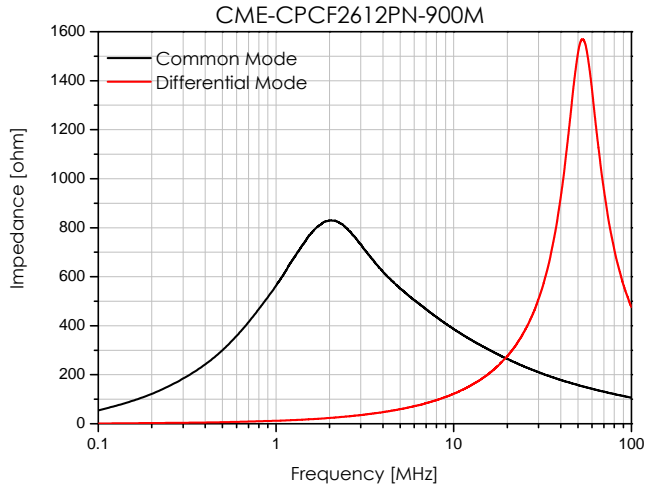

Ilsan Sales Office (KOREA) +82)31-904-1444
 China Sales Office (CHINA) +86)758-278-7031
 Hungary Sales office (EUROPE) +36)1-899-8543

H.K Sales Office (HONGKONG) +852)2711-5551
 LA Sales Office (USA) +1)866-446-3586

- All specifications are subject to change without notice.
- Update date : 2022.03.29