

CMI-CEQ2722B-SERIES

Features

- ▶ Magnetically shielded
- ▶ High current and low profile
- ▶ Flat wire wound
- ▶ Extra solder pad for increased mechanical stability
- ▶ RoHS compliant
- ▶ AEC-Q200 qualified.

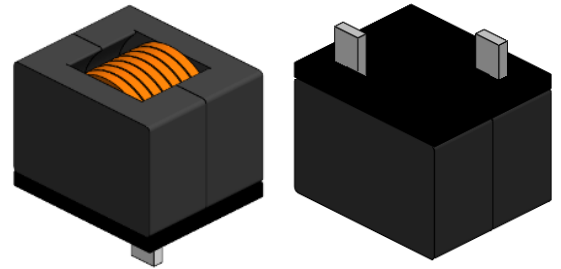

Applications

- ▶ Communication equipment, server, UPS uninterruptible power supply, new energy vehicles, ESS (Energy Storage System), industrial control system, medical instruments and meters, etc.

Dimension (Unit:mm)

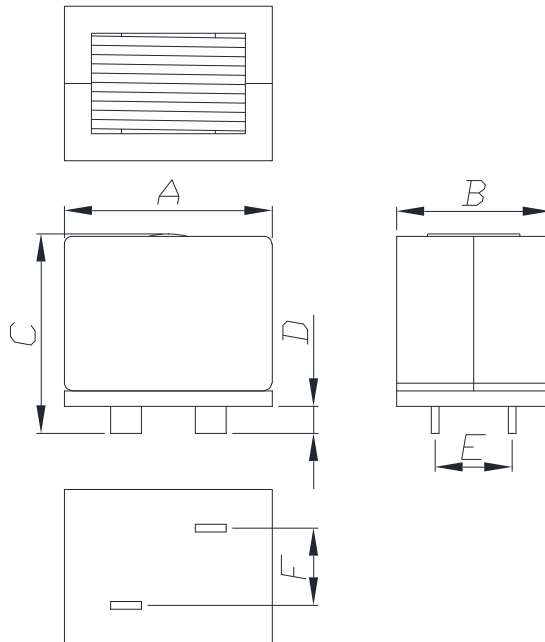

A	B	C	D	E	F
27.5 Max	21.5 Max	26.5 Max	3.5 ±0.5	10.0 Typ.	11.0 Typ.

Land Pattern (Unit:mm)

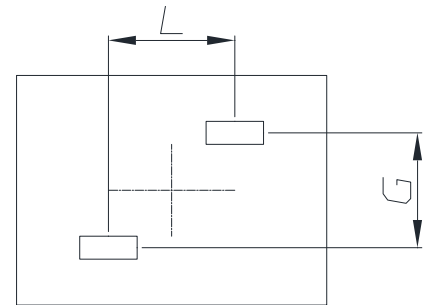

L	G
11.0	10.0

Regulation of part number

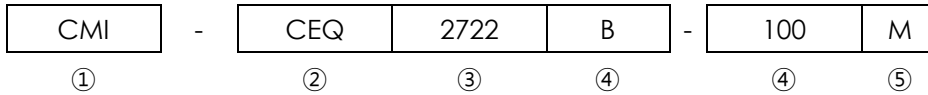

- ① CoilMaster's initial
- ② Series Name : Car metal EQ type inductor
- ③ Core Size (unit:mm)
- ④ Base
- ⑤ Typical inductance value (10.0uH)
- ⑥ Inductance tolerance (±20%)

Specifications

Part Number	Inductance (uH) ±20%	DCR (mohm) Max.(Typ.)	Isat(A) Max.(Typ.)	Itemp(A) Max.(Typ.)	Test Frequency
CMI-CEQ2722B-100M	10.0	2.0(1.7)	60.00(65.00)	50.00(55.00)	100kHz, 1V
CMI-CEQ2722B-130M	13.0	3.0(2.5)	55.00(60.00)	40.00(45.00)	100kHz, 1V

- Isat: When based on the inductance change rate (approximately 30% below in the initial value)
- Itemp: When based on the temperature increase (Temperature increase of approximately 40°C by self heating)
- Operating Temperature Range(including self temperature) : -40°C ~ +165 °c

Note 1 : Circuit design, component placement, PCB trace size and thickness, airflow and other cooling. Provision all affect the part Temperature. Part temperature should be verified in the end application

Korea Sales Office (KOREA)	+82)31-904-1444	H.K Sales Office (HONGKONG)	+852)2711-5551
China Sales Office (CHINA)	+86)0758-683-1444	LA Sales Office (USA)	+1)714-616-6989
Hungary Sales office (EUROPE)	+36)1-404-5832		

- **You can also contact us by e-mail : coilmaster@coilmaster.com**
- All specifications are subject to change without notice.
- Update date : 2024.10.23