

CMI-CMMPP13050HL-SERIES



Features

- ▶ High current and low profile.
- ▶ Metal powder molding type for EMC protection.
- ▶ Available tape and reel for auto insertion.
- ▶ Halogen-Free
- ▶ RoHS compliant
- ▶ AEC-Q200 qualified.

Applications

- ▶ Equipment using for automobiles (ECM, airbags, headlights, electronic Powder steering, motors, ABS, other)

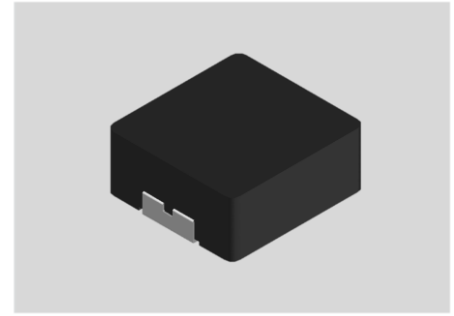

Dimension (Unit:mm)

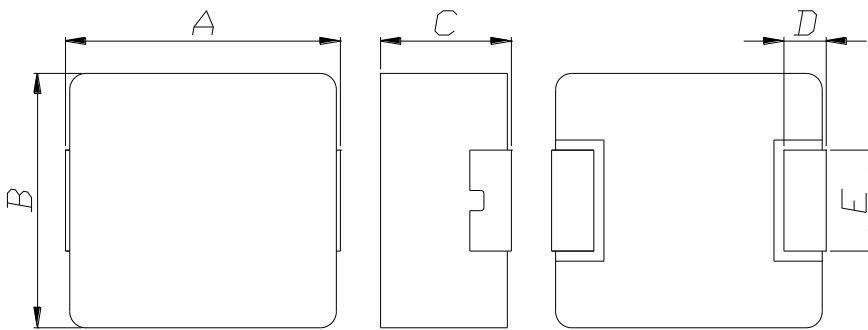

A	B	C	D	E
13.65±0.5	12.6±0.4	5.0 Max	2.5±0.5	5.0±0.2

Land Pattern (Unit:mm)

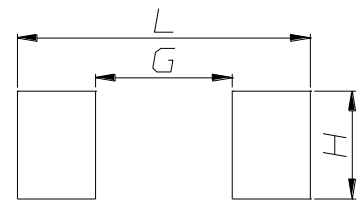

L	G	H
15.0	7.0	5.5

Specifications

Part Number	Inductance (uH) ±20%	DCR(mohm) Max(Typ)	IDC1(A) Max(Typ)	IDC2(A) Max(Typ)	Test Frequency (Hz)
CMI-CMMPP13050HL-1R5M	1.5	4.0(3.3)	36.00(42.00)	28.00(30.50)	1M
CMI-CMMPP13050HL-2R2M	2.2	5.0(4.2)	27.00(32.00)	20.00(22.00)	1M

- IDC1: When based on the inductance change rate (approximately 30% below in the initial value)
- IDC2: When based on the temperature increase (Temperature increase of approximately 40°C by self heating)
- Operating Temperature Range(including self temperature) : -40°C ~ +165 °C

Note 1 : Circuit design, component placement, PCB trace size and thickness, airflow and other cooling. Provision all affect the part Temperature. Part temperature should be verified in the end application.

• You can also contact us by e-mail : coilmaster@coilmaster.com

- All specifications are subject to change without notice.
- Update date : 2020.04.08

DC BIAS vs INDUCTANCE

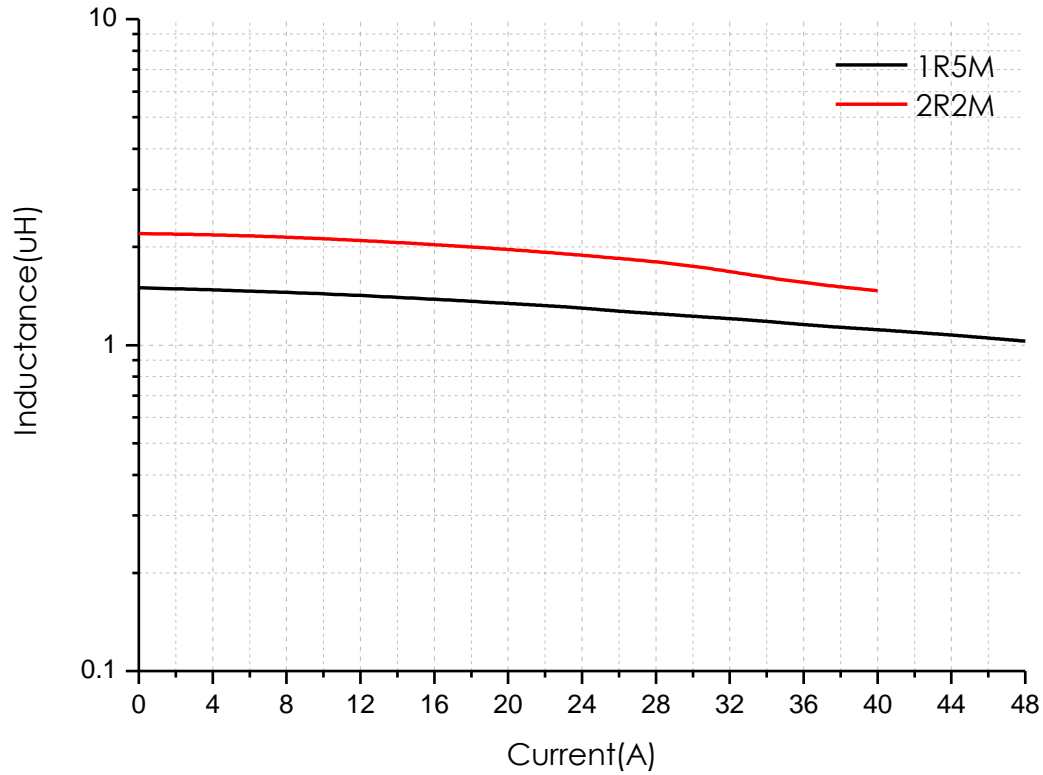

DC BIAS vs TEMPERATURE

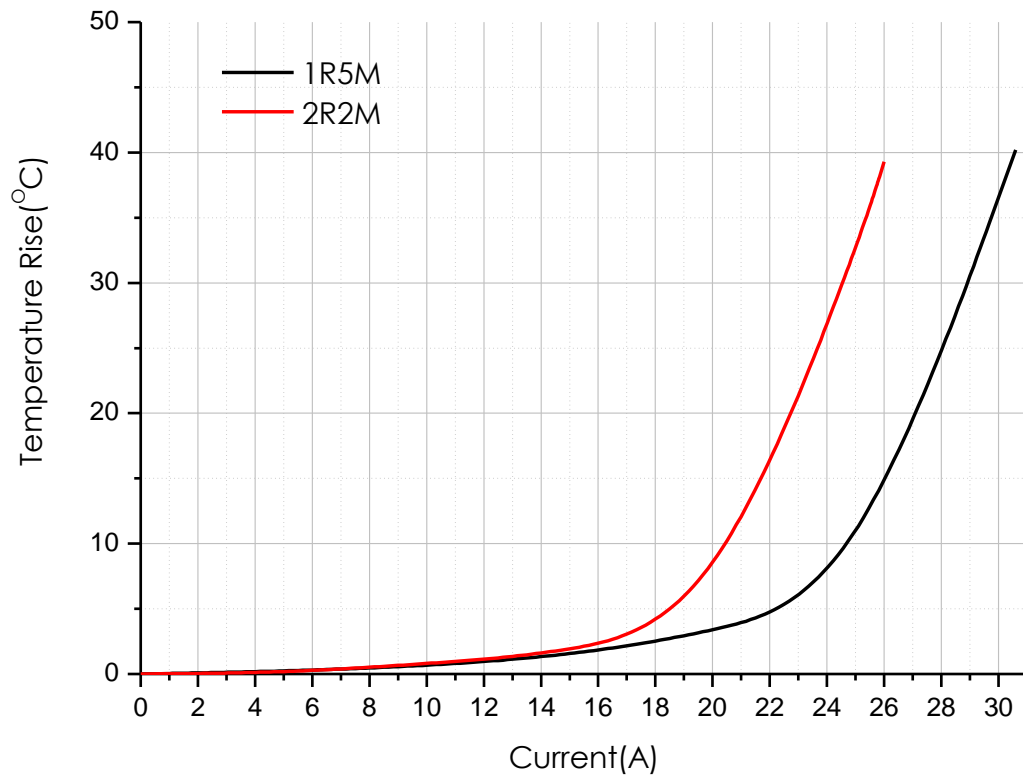

- You can also contact us by e-mail : coilmaster@coilmaster.com
- All specifications are subject to change without notice.
- Update date : 2020.04.08

Packaging

(1) Package quantity : 400 (pcs/reel)

(2) Reel Dimensions (unit:mm)

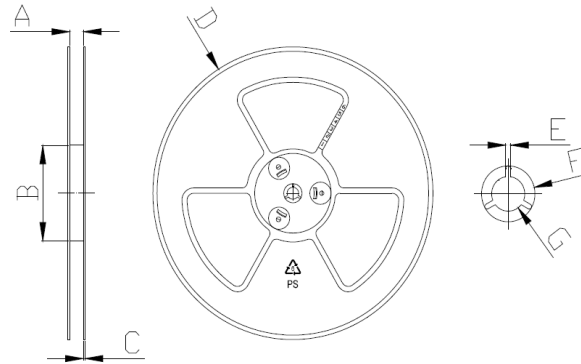

A	B	C	D	E	F	G
24.50	100.0	2.30	330.0	2.3	21.50	13.00
+0.50	+1.00	+0.20	+3.00	+0.30	+0.30	+0.40
-0.50	-1.00	-0.20	-3.00	-0.30	-0.30	-0.40

(3) Tape Dimensions

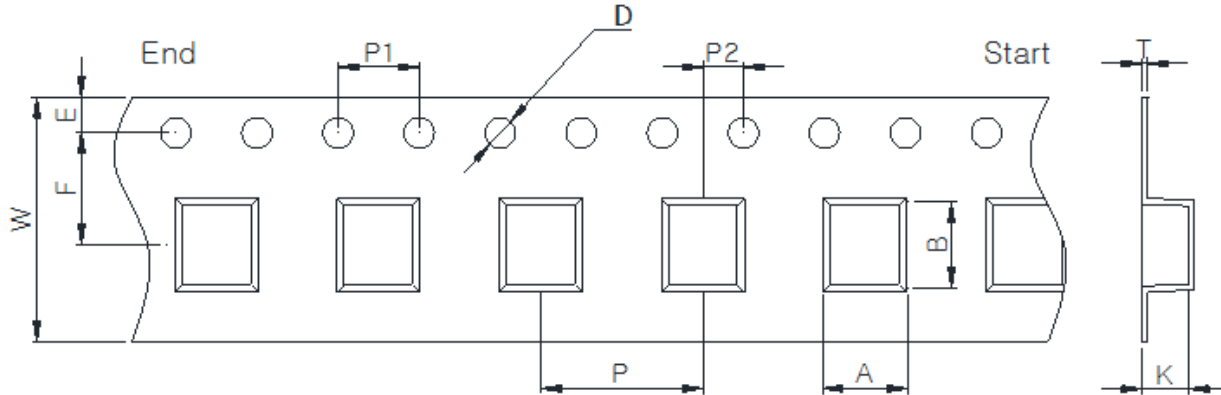

W	A	B	K	E	F	P	P1	P2	D	T
24.00	13.00	14.20	5.60	1.75	11.50	20.00	4.00	2.00	1.50	0.40
+0.30	+0.10	+0.10	+0.15	+0.10	+0.10	+0.10	+0.10	+0.10	+0.10	+0.05
-0.10	-0.10	-0.10	-0.10	-0.10	-0.10	-0.10	-0.10	-0.10	-0.00	-0.05

Ilsan Sales Office (KOREA) +82)31-904-1444
 Shenzhen Sales Office (CHINA) +86)755-8663-6929
 Hungary Sales office (EUROPE) +36)30-913-7706

H.K Sales Office (HONGKONG) +852)2711-5551
 LA Sales Office (USA) +1)866-446-3586

• You can also contact us by e-mail : coilmaster@coilmaster.com

- All specifications are subject to change without notice.
- Update date : 2020.04.08

www.coilmaster.com