

CMI-CSBL1416B-100M

Features

- ▶ Magnetically shielded
- ▶ High current and low profile.
- ▶ Extra solder pad for increased mechanical stability
- ▶ RoHS compliant.
- ▶ AEC-Q200 qualified.

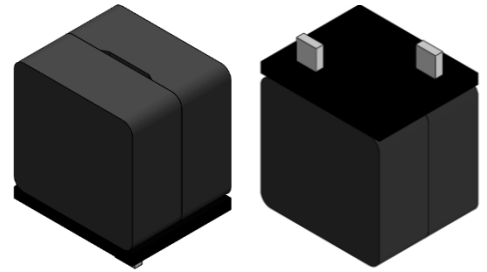

Applications

- ▶ Equipment using for automobiles (ECM, Airbags, Headlights, Electronic Power Steering, Motors, ABS, other) ESS (Energy Storage System)

Dimension (Unit: mm)

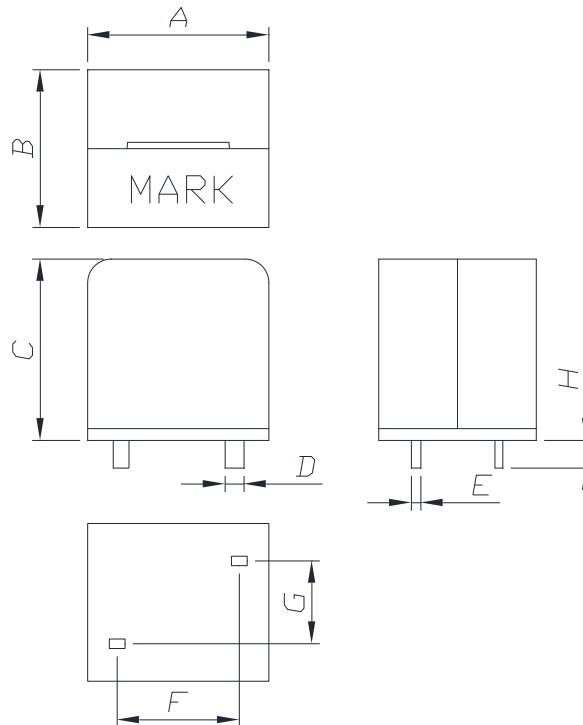

A	B	C	D	E	F	G	H
14.0 ±0.3	9.6 ±0.5	16.0 Max.	1.8 ±0.1	0.45 ±1	9.1 ±0.5	4.4 ±0.5	5.0 ±0.5

- You can also contact us by e-mail : coilmaster@coilmaster.com
- All specifications are subject to change without notice.
- Update date : 2024.10.23

Regulation of part number

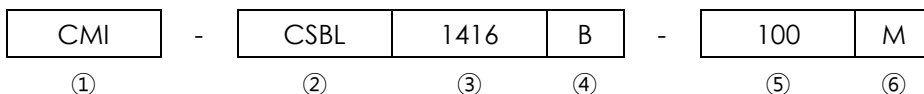

- ① CoilMaster's initial
- ② Series Name : Car Shield Base Lead type Power inductor
- ③ Core Size (unit:mm)
- ④ Base
- ⑤ Typical inductance value (10.0uH)
- ⑥ Inductance tolerance ($\pm 20\%$)

Specifications

Part Number	Inductance (uH) $\pm 20\%$	DCR (mohm) Max.	Isat(A) Max.	Itemp(A) Max.	Test Frequency (Hz)
CMI-CSBL1416B-100M	10	8.5	12.0	8.0	1kHz, 0.25V

- Isat: When based on the inductance change rate (approximately 30% below in the initial value)
- Itemp: When based on the temperature increase (Temperature increase of approximately 40°C by self heating)
- Operating Temperature Range(including self temperature) : -40°C ~ +125 °c.

Korea Sales Office (KOREA)	+82)31-904-1444	H.K Sales Office (HONGKONG)	+852)2711-5551
China Sales Office (CHINA)	+86)0758-683-1444	LA Sales Office (USA)	+1)714-616-6989
Hungary Sales office (EUROPE)	+36)1-404-5832		

- **You can also contact us by e-mail : coilmaster@coilmaster.com**
- All specifications are subject to change without notice.
- Update date : 2024.10.23