

CMI-CSSMF10060MH-SERIES

Features

- ▶ High current and low profile/ Low DC resistance
- ▶ Magnetic shielding for high-density packaging
- ▶ Available tape and reel for auto insertion.
- ▶ Halogen-Free / RoHS compliant.
- ▶ AEC-Q200 qualified.

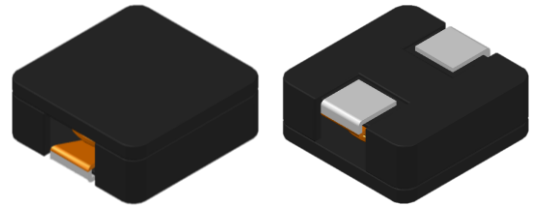

Applications

- ▶ Equipment using for automobile (ECM, Airbags, Headlights, Electronic Power Steering, Motors, ABS, other)
Soft saturation makes them ideal for VRD/VRM applications

Dimension (Unit:mm)

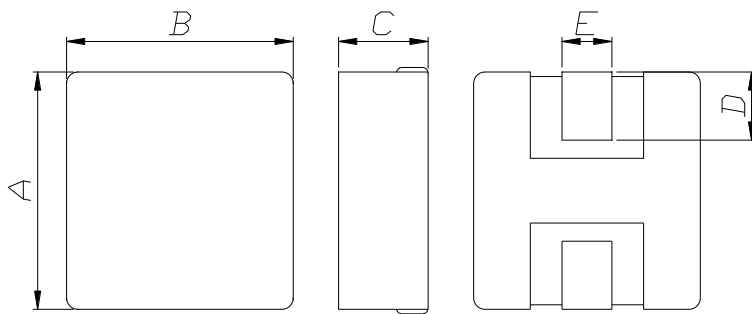

Value	A	B	C	D	E
R38~2R2	11.2	10.2±0.5	5.7±0.3	2.5±0.5	2.5±0.3
2R9~270	Max.				2.0±0.3

Land Pattern (Unit:mm)

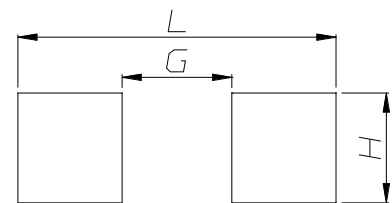

L	G	H
11.6	4.0	4.0

Regulation of part number

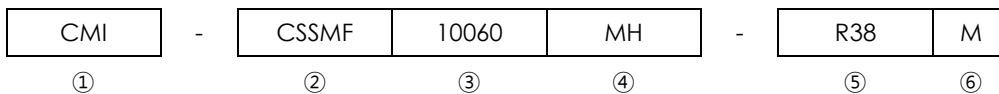

- ① CoilMaster's initial
- ② Series Name : Car Metal material Square Shield Flat wire type Power inductor
- ③ Core Size (unit:mm)
- ④ Material
- ⑤ Typical inductance value (0.38uH)
- ⑥ Inductance tolerance (±20%)

• You can also contact us by e-mail : coilmaster@coilmaster.com
 • All specifications are subject to change without notice.
 • Update date : 2021.03.10

Specifications

Part Number	Inductance (uH) ±20%	DCR(mohm) Max.(Typ.)	Isat(A) Typ.	Irms(A) Typ.	Test Frequency (Hz)
CMI-CSSMF10060MH-R38M	0.38	0.77(0.67)	54.00	25.00	100k
CMI-CSSMF10060MH-1R0M	1.0	1.90(1.65)	30.00	21.00	100k
CMI-CSSMF10060MH-1R5M	1.5	2.85(2.47)	26.00	19.00	100k
CMI-CSSMF10060MH-2R2M	2.2	4.20(3.60)	23.00	16.00	100k
CMI-CSSMF10060MH-2R9M	2.9	5.15(4.45)	20.00	14.00	100k
CMI-CSSMF10060MH-3R8M	3.8	6.77(5.89)	17.00	12.00	100k
CMI-CSSMF10060MH-4R7M	4.7	8.15(7.08)	16.00	10.80	100k
CMI-CSSMF10060MH-5R6M	5.6	10.60(9.23)	14.00	9.60	100k
CMI-CSSMF10060MH-6R8M	6.8	12.50(10.90)	13.00	8.70	100k
CMI-CSSMF10060MH-8R2M	8.2	15.60(13.60)	11.00	7.80	100k
CMI-CSSMF10060MH-100M	10.0	18.70(16.30)	10.00	6.20	100k
CMI-CSSMF10060MH-150M	15.0	24.00(20.90)	8.70	5.60	100k
CMI-CSSMF10060MH-220M	22.0	36.30(31.60)	6.50	4.50	100k
CMI-CSSMF10060MH-270M	27.0	48.50(42.20)	5.80	4.00	100k

- Isat: When based on the inductance change rate (approximately 30% below in the initial value)
- Iirms: When based on the temperature increase (Temperature increase of approximately 50°C by self heating)
- Operating Temperature Range(including self temperature) : -40°C ~ +165 °c

Note 1 : Circuit design, component placement, PCB trace size and thickness, airflow and other cooling. Provision all affect the part Temperature. Part temperature should be verified in the end application.

▪ You can also contact us by e-mail : coilmaster@coilmaster.com

- All specifications are subject to change without notice.
- Update date : 2021.03.10

www.coilmaster.com

Packaging

(1) Package quantity : 400 (pcs/reel)

(2) Reel Dimensions (unit:mm)



A	B	C	D	E	F	G
24.50	100.0	2.30	330.0	2.30	21.50	13.00
+0.50	+1.00	+0.20	+3.00	+0.30	+0.30	+0.50
-0.50	-1.00	-0.20	-3.00	-0.30	-0.30	-0.20

(3) Tape Dimensions

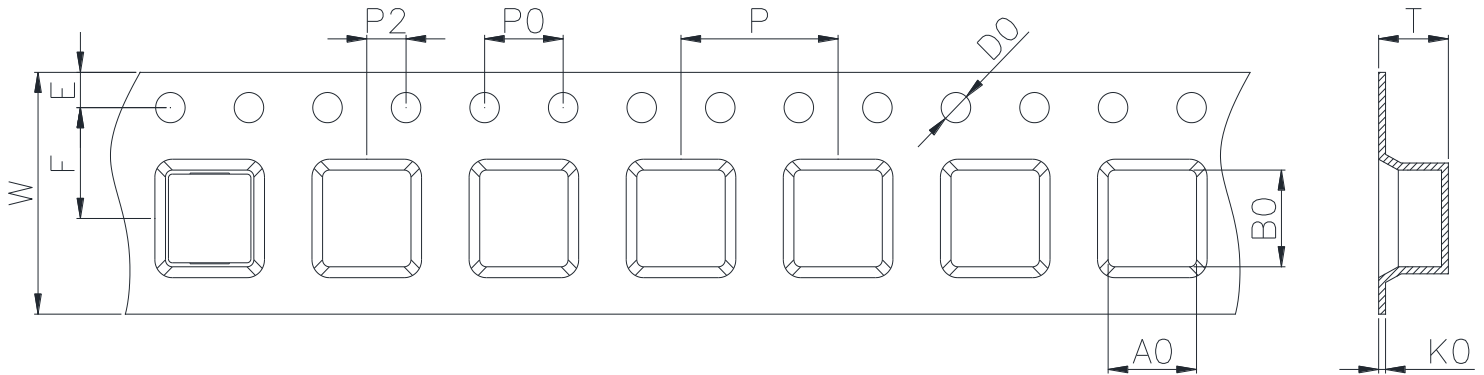

W	A0	B0	K0	E	F	P	P0	P2	D0/D1	T
24.00	10.80	11.30	6.30	1.75	11.50	16.00	4.00	2.00	1.50	0.40
+0.30	+0.10	+0.10	+0.10	+0.10	+0.10	+0.10	+0.10	+0.10	+0.05	+0.05
-0.30	-0.10	-0.10	-0.10	-0.10	-0.10	-0.10	-0.10	-0.10	-0.05	-0.05

Ilisan Sales Office (KOREA) +82)31-904-1444
 Shenzhen Sales Office (CHINA) +86)755-8663-6929
 Hungary Sales office (EUROPE) +36)30-913-7706

H.K Sales Office (HONGKONG) +852)2711-5551
 LA Sales Office (USA) +1)866-446-3586

• You can also contact us by e-mail : coilmaster@coilmaster.com

- All specifications are subject to change without notice.
- Update date : 2021.03.10

www.coilmaster.com