

CMI-DP5010NH-SERIES



Features

- ▶ SMD inductor.
- ▶ Resin shielded construction.
- ▶ Available tape and reel for auto insertion.
- ▶ RoHS compliant
- ▶ Halogen-Free

Applications

- ▶ For small DC/DC converter (LCD/LED/OLED display, HDD, DSC etc).
- ▶ For Power supply circuits.



Dimension (Unit:mm)

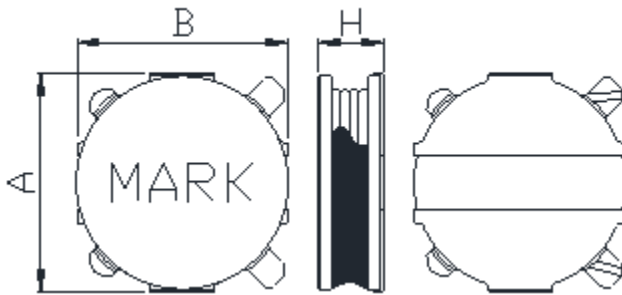

A	B	H
5.0±0.2	5.0±0.2	1.0Max

Land Pattern (Unit:mm)

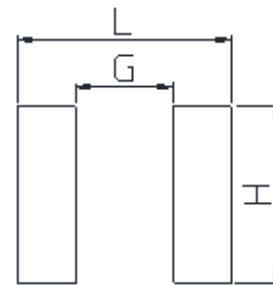

L	G	H
5.10	2.30	4.20

Specifications

Part Number	Inductance (uH)	Tolerance (±)	DCR (mohm) ±20%	IDC1(A) Max	IDC2(A) Max	Test Frequency (Hz)
CMI-DP5010NH-1R0M	1.0	20%	70	2.35	1.80	100k
CMI-DP5010NH-2R2M	2.2	20%	105	1.50	1.40	100k
CMI-DP5010NH-3R3M	3.3	20%	125	1.40	1.30	100k
CMI-DP5010NH-4R7M	4.7	20%	145	1.20	1.20	100k
CMI-DP5010NH-6R8M	6.8	20%	185	1.00	1.00	100k
CMI-DP5010NH-100M	10	20%	250	0.90	0.90	100k
CMI-DP5010NH-150M	15	20%	400	0.70	0.70	100k
CMI-DP5010NH-220M	22	20%	600	0.55	0.45	100k

- IDC1: When based on the inductance change rate (approximately 20% below in the initial value)
- IDC2: When based on the temperature increase (Temperature increase of approximately 40°C by self heating)
- Operating temperature range : -40°C ~ +125°C (Including self-heating)

Ilsan Sales Office (KOREA) +82)31-904-1444
 Shenzhen Sales Office (CHINA) +86)755-8663-6929
 Hungary Sales office (EUROPE) +36)30-913-7706

H.K Sales Office (HONGKONG) +852)2711-5551
 LA Sales Office (USA) +1)866-446-3586

• You can also contact us by e-mail : coilmaster@coilmaster.com

- All specifications are subject to change without notice.
- Update date : 2015.11.19

www.coilmaster.com