

CMI-DSS6028NH-SERIES



Features

- ▶ Small and Low profile inductor
- ▶ It corresponds to High current.
- ▶ Simple and Shield structure.
- ▶ Takes up less PCB real estate and save more power
- ▶ Available tape and reel for auto insertion.
- ▶ RoHs compliant
- ▶ Halogen-Free



Applications

- ▶ For small DC/DC converter (cellular Phone, LCD/LED/OLED display etc).

Dimension (Unit:mm)

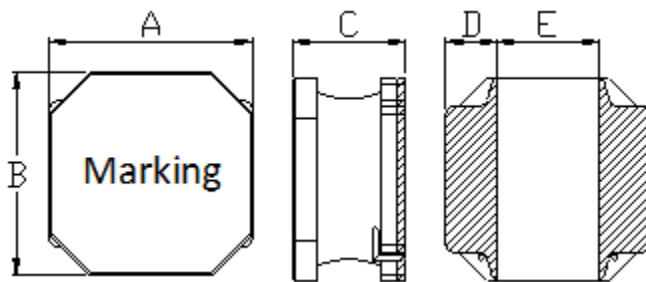

| | | | | |
|---------|---------|----------|---------|---------|
| A | B | C | D | E |
| 6.0±0.3 | 6.0±0.3 | 2.8 Max. | 1.7±0.3 | 2.6±0.3 |

Land Pattern (Unit:mm)

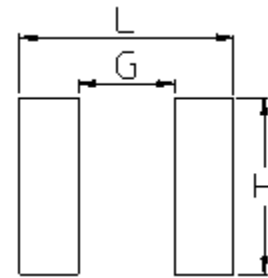

| | | |
|-----|-----|-----|
| L | G | H |
| 6.0 | 2.4 | 5.7 |

Specifications

| Part Number | Inductance (μH) | Tolerance (±) | DCR (mΩ) ±30% | Isat (A) Max. | Itemp (A) Max. | SRF (Min) (MHz) |
|--------------------|-----------------|---------------|---------------|---------------|----------------|-----------------|
| CMI-DSS6028NH-1R0N | 1.0 | 30% | 12 | 6.00 | 5.20 | 70 |
| CMI-DSS6028NH-1R5N | 1.5 | 30% | 15 | 5.75 | 4.58 | 65 |
| CMI-DSS6028NH-1R8N | 1.8 | 30% | 17 | 5.50 | 4.20 | 60 |
| CMI-DSS6028NH-2R2N | 2.2 | 30% | 20 | 5.10 | 3.75 | 48 |
| CMI-DSS6028NH-2R7N | 2.7 | 30% | 20 | 4.15 | 3.75 | 48 |
| CMI-DSS6028NH-3R3N | 3.3 | 30% | 25 | 3.80 | 3.48 | 41 |
| CMI-DSS6028NH-4R7N | 4.7 | 30% | 30 | 3.00 | 3.08 | 35 |
| CMI-DSS6028NH-6R8M | 6.8 | 20% | 47 | 2.60 | 2.40 | 27 |
| CMI-DSS6028NH-100M | 10 | 20% | 72 | 2.04 | 1.95 | 23 |
| CMI-DSS6028NH-120M | 12 | 20% | 80 | 1.80 | 1.85 | 18 |
| CMI-DSS6028NH-150M | 15 | 20% | 120 | 1.75 | 1.45 | 18 |

• You can also contact us by e-mail : coilmaster@coilmaster.com

- All specifications are subject to change without notice
- Update date : 2017.01.10

| Part Number | Inductance (μH) | Tolerance (±) | DCR (mΩ) ±30% | Isat (A) Max. | Itemp (A) Max. | SRF (Min) (MHz) |
|--------------------|-----------------|---------------|---------------|---------------|----------------|-----------------|
| CMI-DSS6028NH-180M | 18 | 20% | 125 | 1.52 | 1.45 | 15 |
| CMI-DSS6028NH-220M | 22 | 20% | 140 | 1.45 | 1.40 | 14 |
| CMI-DSS6028NH-330M | 33 | 20% | 185 | 1.35 | 1.22 | 12 |
| CMI-DSS6028NH-470M | 47 | 20% | 315 | 1.15 | 1.06 | 9.5 |
| CMI-DSS6028NH-680M | 68 | 20% | 360 | 0.80 | 0.86 | 7.7 |
| CMI-DSS6028NH-820M | 82 | 20% | 500 | 0.80 | 0.70 | 7.7 |
| CMI-DSS6028NH-101M | 100 | 20% | 500 | 0.65 | 0.70 | 7.1 |
| CMI-DSS6028NH-102M | 1000 | 20% | 5800 | 0.18 | 0.20 | 1.5 |
| | | | | | | |
| | | | | | | |

- Inductance Tested at 100kHz, 1Vrms (20°C)
- Isat: When based on the inductance change rate (approximately 30% below in the initial value)
- Itemp: When based on the temperature increase (Temperature increase of approximately 40°C by self heating)
- Operating Temperature Range(including self temperature) : -25°C ~ +125°C

Note 1 : Circuit design, component placement, PCB trace size and thickness, airflow and other cooling. Provision all affect the part Temperature. Part temperature should be verified in the end application

Ilsan Sales Office (KOREA) +82)31-904-1444
 Shenzhen Sales Office (CHINA) +86)755-8663-6929
 Hungary Sales office (EUROPE) +36)30-913-7706

H.K Sales Office (HONGKONG) +852)2711-5551
 LA Sales Office (USA) +1)866-446-3586

▪ You can also contact us by e-mail : coilmaster@coilmaster.com

- All specifications are subject to change without notice
- Update date : 2017.01.10

www.coilmaster.com