

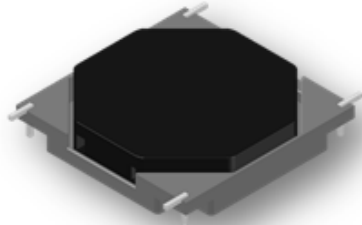

MMPB3509-600

Picture



Features

- ▶ High current
- ▶ Low profile
- ▶ Low magnetic loss
- ▶ RoHS compliant

Applications

- ▶ Audio AMP, TV SMPS, Slim Adapter, AV equipment, digital consumer electronics

Dimension (Unit:mm)

※ Unlabeled Tolerance : ± 0.2

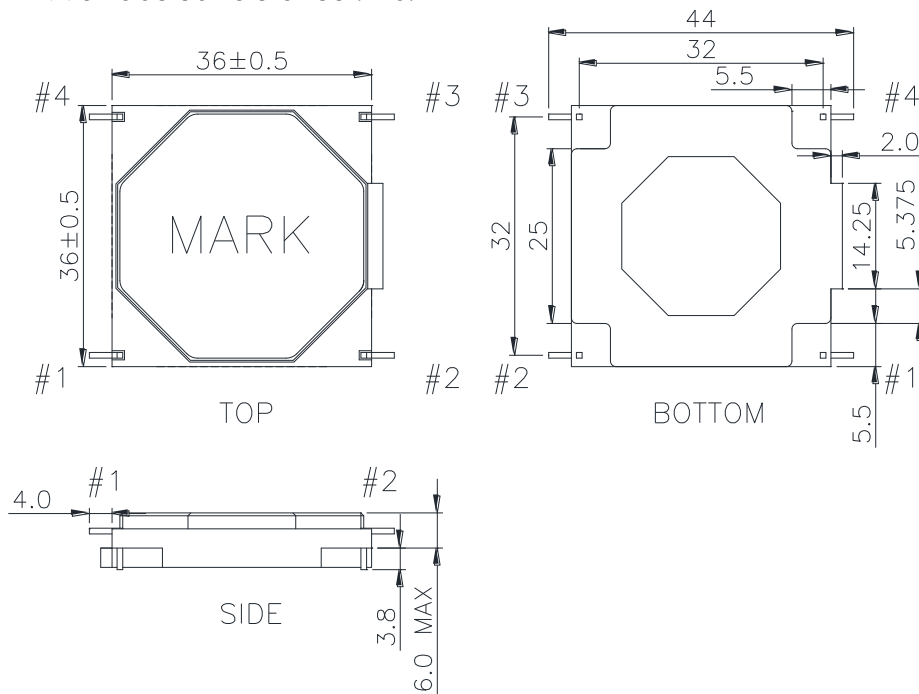

Schematic Diagram



Specifications

Part No.	Inductance (μH) $\pm 7\%$	DCR ($\text{m}\Omega$) Max.	Saturation Current(A) @25 °c	Test Frequency (Hz)
MMPB3509-600	60	48	11.4	100k

- Saturation Current : Depends on inductance saturation.
(Inductance reduction from initial shall be under 20%)
- Test Condition : Temperature 20 °c \pm 5 °c, Humidity 65% \pm 20

Ilsan Sales Office (KOREA) +82)31-904-1444
 Shenzhen Sales Office (CHINA) +86)755-8663-6929
 Hungary Sales office (EUROPE) +36)30-913-7706

H.K Sales Office (HONGKONG) +852)2711-5551
 LA Sales Office (USA) +1)866-446-3586

▪ You can also contact us by e-mail : coilmaster@coilmaster.com

- All specifications are subject to change without notice.
- Update date : 2019.01.04

www.coilmaster.com