

CMI-MPLD13080M1-SERIES

Features

- ▶ High Current and Low DCR.
- ▶ Ferrite Core type for EMC protection.
- ▶ Available tape and reel for auto insertion.
- ▶ RoHS compliant.
- ▶ Halogen-Free

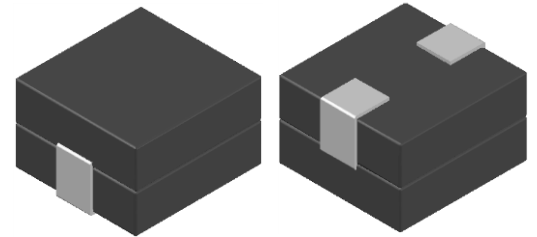

Applications

- ▶ For DC/DC converter, AV equipment, digital consumer electronics.

Dimension (Unit:mm)

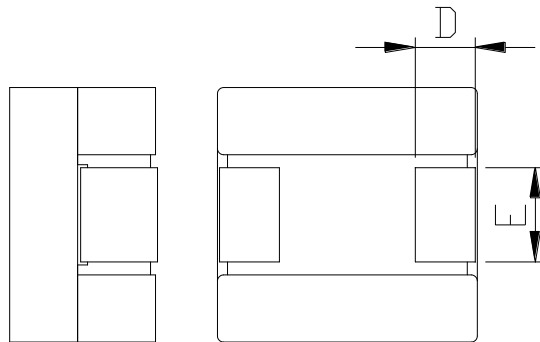
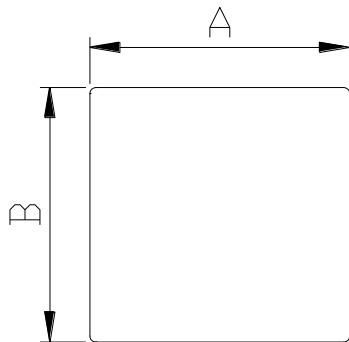

Land Pattern (Unit:mm)

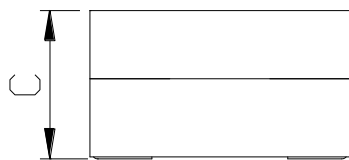
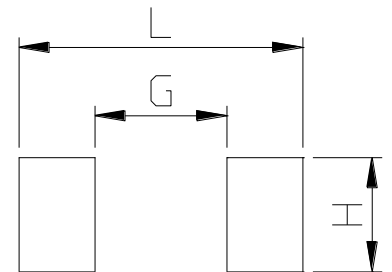

A	B	C	D	E	L	G	H
13.2 ±0.5	12.7 ±0.4	8.0 Max.	4.0 ±0.3	4.7 ±0.3	14.2	4.6	5.7

Regulation of part number

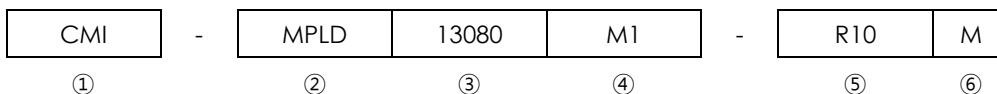

- ① CoilMaster's initial
- ② Series Name : Magnetic Pin Low Dcr power inductor
- ③ Core Size (unit:mm)
- ④ Material
- ⑤ Typical inductance value (0.1 uH)
- ⑥ Inductance tolerance (±20%)

Specifications

Part Number	Inductance (uH) ±20%	DCR(mohm) Max.(Typ.)	Isat(A) Max.(Typ.)	Itemp(A) Max.(Typ.)	Test Frequency (Hz)
CMI-MPLD13080M1-R10M	0.10	0.5(0.3)	100.0(110.0)	80.0(90.0)	100K
CMI-MPLD13080M1-R22M	0.22	0.5(0.3)	80.0(90.0)	80.0(90.0)	100K
CMI-MPLD13080M1-R30M	0.30	0.5(0.3)	47.0(52.0)	80.0(90.0)	100K
CMI-MPLD13080M1-R50M	0.50	0.5(0.3)	28.0(33.0)	80.0(90.0)	100K

- Isat: When based on the inductance change rate (Approximately 30% below in the initial value)
- Itemp: When based on the temperature increase (Temperature increase of approximately 40°C by self heating)
- Operating Temperature Range (including self temperature) : -40°C ~ +125 °c

Note 1 : Circuit design, component placement, PCB trace size and thickness, airflow and other cooling. Provision all affect the part Temperature. Part temperature should be verified in the end application.

▪ You can also contact us by e-mail : coilmaster@coilmaster.com

- All specifications are subject to change without notice.
- Update date : 2024.03.11

Packaging

(1) Package quantity : 300 (pcs/reel)

(2) Reel Dimensions (unit:mm)

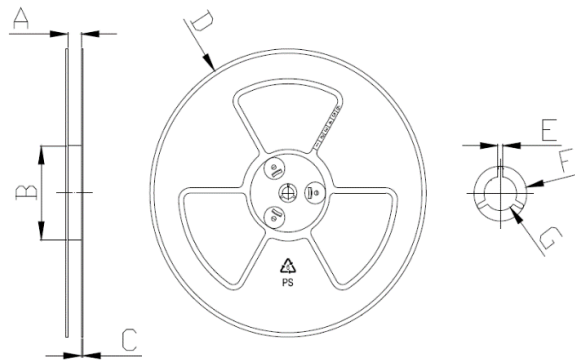

A	B	C	D	E	F	G
24.50	100.0	2.30	330.0	2.30	21.50	13.00
+0.50	+1.00	+0.20	+3.00	+0.30	+0.30	+0.50
-0.50	-1.00	-0.20	-3.00	-0.30	-0.30	-0.20

(3) Tape Dimensions

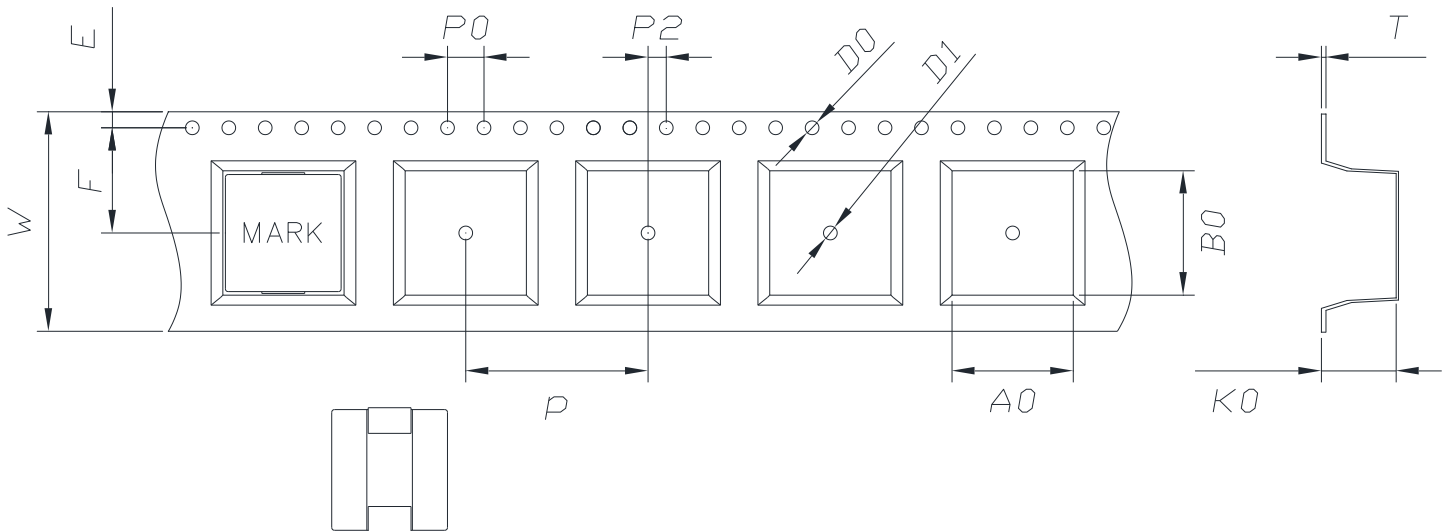

W	A0	B0	K0	E	F	P	P0	P2	D0/D1	T
24.00	13.30	13.60	8.20	1.75	11.50	20.00	4.00	2.00	1.50	0.50
+0.30	+0.10	+0.10	+0.10	+0.10	+0.10	+0.10	+0.10	+0.10	+0.10	+0.05
-0.30	-0.10	-0.10	-0.10	-0.10	-0.10	-0.10	-0.10	-0.10	-0.00	-0.05

Korea Sales Office (KOREA) +82)31-904-1444
 China Sales Office (CHINA) +86)0758-683-1444
 Hungary Sales office (EUROPE) +36)1-404-5832

H.K Sales Office (HONGKONG) +852)2711-5551
 LA Sales Office (USA) +1)714-616-6989

• You can also contact us by e-mail : coilmaster@coilmaster.com

- All specifications are subject to change without notice.
- Update date : 2024.03.11

www.coilmaster.com