

CMI-TSCC1814N-SERIES



Picture



Features

- ▶ shielded construction
- ▶ Compact Size
- ▶ High inductance, High current
- ▶ RoHS compliant

Applications

- ▶ LED Drive Circuit, LED Buck Boost, Slim TV SMPS

Dimension (Unit:mm)

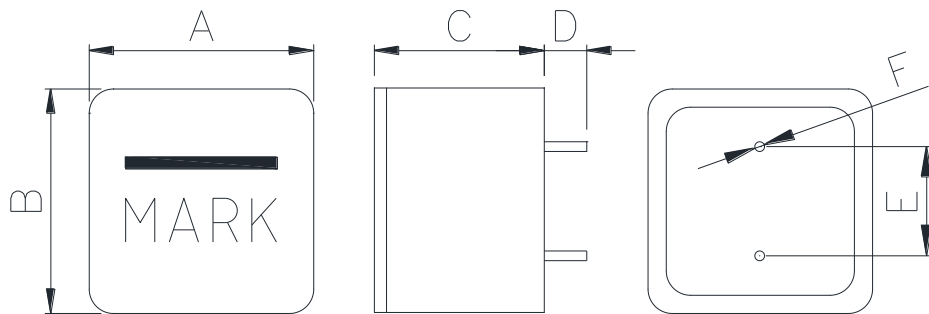

Schematic Diagram

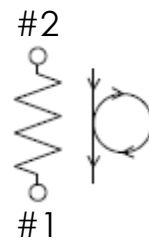

A	B	C	D	E	F
18.5±0.5	18.5±0.5	14.0 Max	3.5±0.5	9.0±0.5	0.8±0.1

Specifications

Part No.	Inductance (μH) $\pm 10\%$	DCR ($\text{m}\Omega$) Max.	Saturation Current(A)		Test Frequency (Hz)
			25 °c	100 °c	
CMI-TSCC1814N-281K	280	500	3.30	3.20	100k
CMI-TSCC1814N-1651K	1650	1600	2.00	1.70	100k
CMI-TSCC1814N-252K	2500	2800	1.60	1.30	100k
CMI-TSCC1814N-302K	3000	3000	1.40	1.20	100k

- Saturation Current : Depends on inductance saturation.
(Inductance reduction from initial shall be under 20%)
- Test Condition : Temperature 20 °c \pm 5 °c, Humidity 65% \pm 20%

Ilsan Sales Office (KOREA) +82)31-904-1444

Shenzhen Sales Office (CHINA) +86)755-8663-6929

Hungary Sales office (EUROPE) +36)30-913-7706

H.K Sales Office (HONGKONG) +852)2711-5551

LA Sales Office (USA) +1)866-446-3586

• You can also contact us by e-mail : coilmaster@coilmaster.com

- All specifications are subject to change without notice.
- Update date : 2018.07.30

www.coilmaster.com