

CME-CSCF3225L-101T15

Features

- ▶ High common mode impedance at high frequency effects
Excellent noise suppression performance.
- ▶ Realizes small size and low profile.
- ▶ RoHS compliant.
- ▶ High reliability test meet AEC-Q200.

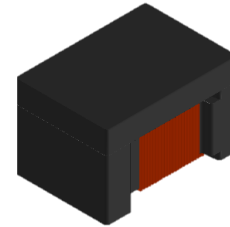

Applications

- ▶ A²B system.

Dimension (Unit:mm)

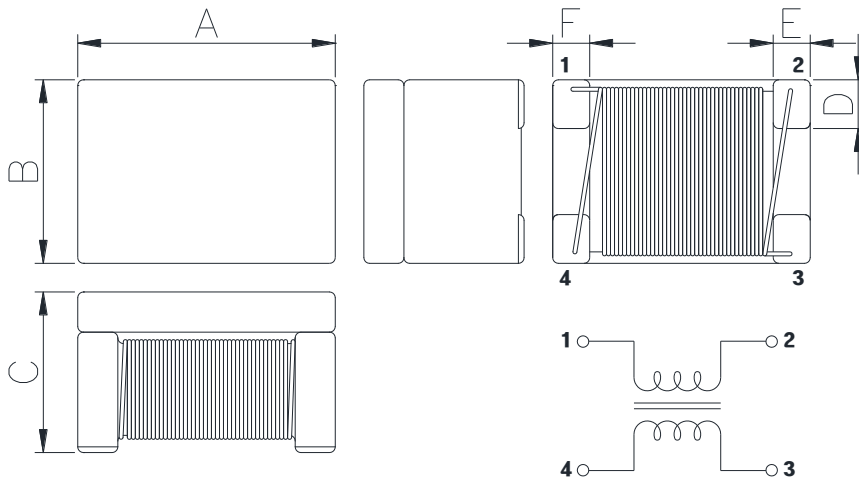

Land Pattern (Unit:mm)

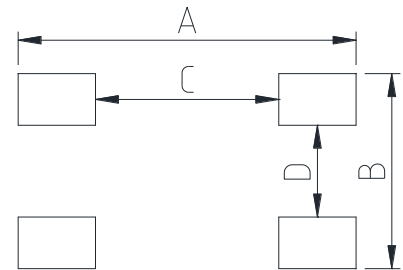

A	B	C	D	E	F
3.2±0.2	2.5±0.2	2.5 Max.	0.8±0.2	0.5±0.2	0.5±0.2

A	B	C	D
3.7	2.3	2.2	0.6

Regulation of part number

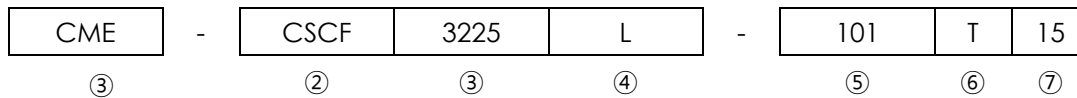

- ① CoilMaster's initial
- ② Series Name : Car Signal Line Common mode Filter
- ③ Core Size (unit:mm)
- ④ Type
- ⑤ Common mode inductance value (100 uH)
- ⑥ Packing type
- ⑦ Rated Current

Specifications

Part Number	Common Mode Inductance (μH)	Common Mode Inductance Tolerance	DCR (Ω) Max.	Rated Current (mA) Max.	Insulation Resistance (MΩ) Min.	Rated Voltage (V) Max.
CME-CSCF3225L-101T15	100	+50/-30%	1.5	150	10	80

- Inductance test condition : 100 kHz
- Operating Temperature Range : -40°C ~ +125 °C

Impedance VS Frequency characteristics

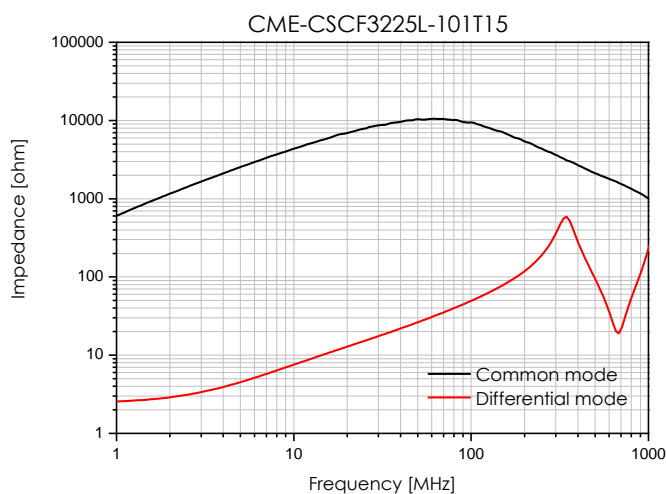

Korea Sales Office (KOREA) +82)31-904-1444
 China Sales Office (CHINA) +86)0758-683-1444
 Hungary Sales office (EUROPE) +36)1-404-5832

H.K Sales Office (HONGKONG) +852)2711-5551
 LA Sales Office (USA) +1)714-616-6989

- You can also contact us by e-mail : coilmaster@coilmaster.com
- All specifications are subject to change without notice.
- Update date : 2023.07.03