

# CMI-MMPP10075LL-SERIES

## Features

- ▶ Metal powder molding type for EMC protection.
- ▶ Available tape and reel for auto insertion.
- ▶ Halogen-Free.
- ▶ RoHS compliant.

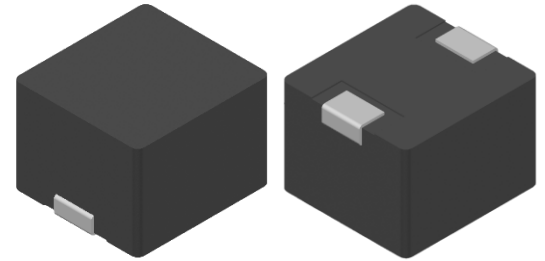

## Applications

- ▶ For DC/DC converter, AV equipment digital consumer electronics

## Dimension (Unit:mm)

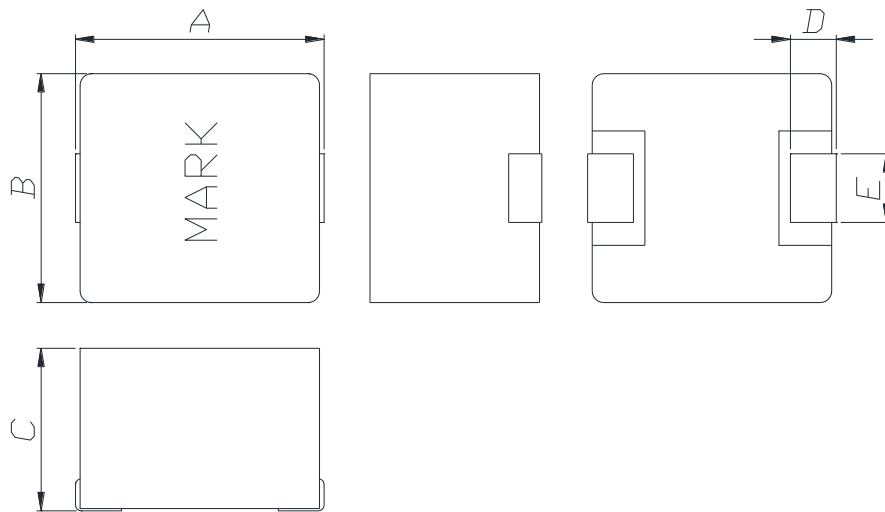

| A          | B         | C        | D        | E        |
|------------|-----------|----------|----------|----------|
| 10.85 ±0.5 | 10.0 ±0.4 | 7.5 Max. | 2.0 ±0.3 | 3.0 ±0.2 |

## Land Pattern (Unit:mm)

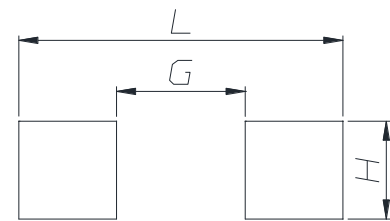

| L    | G   | H   |
|------|-----|-----|
| 13.6 | 5.4 | 4.1 |

## Regulation of part number

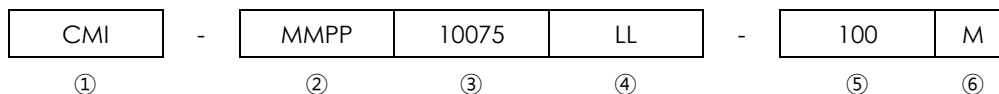

- ① CoilMaster's initial
- ② Series Name : Metal Molded Pin type Power inductor
- ③ Core Size (unit:mm)
- ④ Material
- ⑤ Typical inductance value (10uH)
- ⑥ Inductance tolerance ( $\pm 20\%$ )

## Specifications

| Part Number          | Inductance (uH) $\pm 20\%$ | DCR(mohm) Max.(Typ.) | Isat(A) Max.(Typ.) | Itemp(A) Max.(Typ.) | Test Frequency (Hz) |
|----------------------|----------------------------|----------------------|--------------------|---------------------|---------------------|
| CMI-MMPP10075LL-100M | 10                         | 19(16)               | 14.5(16.0)         | 13.2(14.7)          | 1M                  |
|                      |                            |                      |                    |                     |                     |
|                      |                            |                      |                    |                     |                     |
|                      |                            |                      |                    |                     |                     |

- Isat: When based on the inductance change rate (Approximately 30% below in the initial value)
- Itemp: When based on the temperature increase (Temperature increase of approximately 40°C by self heating)
- Operating Temperature Range (including self temperature) : -40°C ~ +125 °c

Note 1 : Circuit design, component placement, PCB trace size and thickness, airflow and other cooling. Provision all affect the part Temperature. Part temperature should be verified in the end application.

## Electrical characteristics

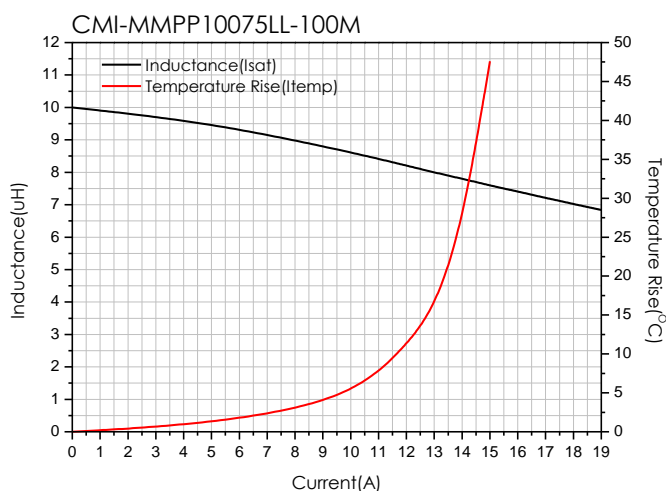

- You can also contact us by e-mail : [coilmaster@coilmaster.com](mailto:coilmaster@coilmaster.com)
- All specifications are subject to change without notice.
- Update date : 2020.09.17

## Packaging

(1) Package quantity : 450 (pcs/reel)

(2) Reel Dimensions (unit:mm)

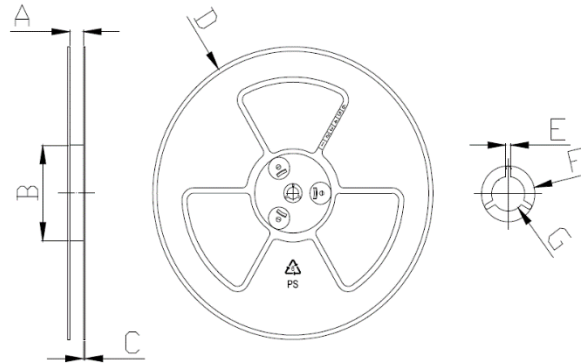

| A     | B     | C     | D     | E     | F     | G     |
|-------|-------|-------|-------|-------|-------|-------|
| 24.50 | 100.0 | 2.30  | 330.0 | 2.30  | 21.50 | 13.00 |
| +0.50 | +1.00 | +0.20 | +3.00 | +0.30 | +0.30 | +0.50 |
| -0.50 | -1.00 | -0.20 | -3.00 | -0.30 | -0.30 | -0.20 |

(3) Tape Dimensions

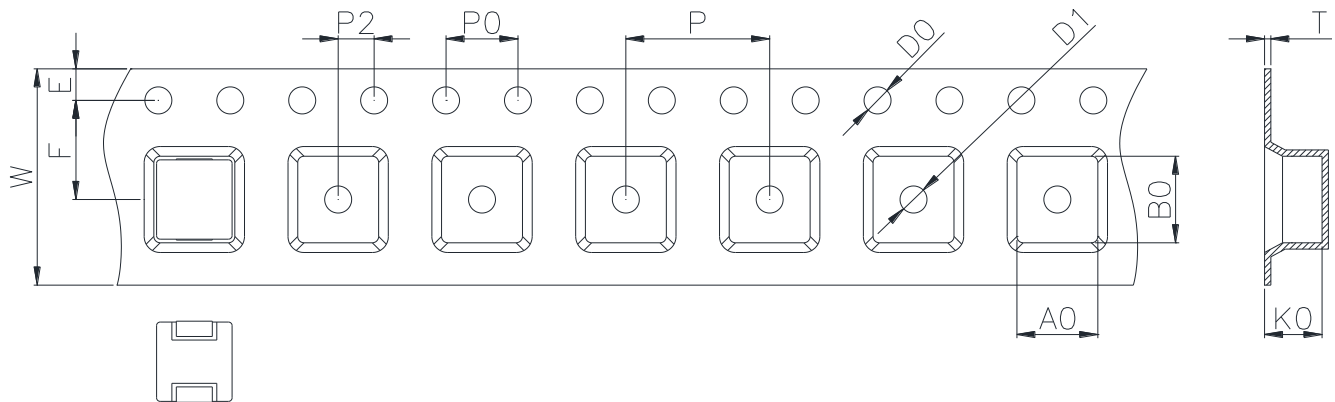

| W     | A0    | B0    | K0    | E     | F     | P     | P0    | P2    | D0/D1 | T     |
|-------|-------|-------|-------|-------|-------|-------|-------|-------|-------|-------|
| 24.00 | 10.50 | 11.50 | 7.60  | 1.75  | 11.50 | 16.00 | 4.00  | 2.00  | 1.50  | 0.40  |
| +0.30 | +0.10 | +0.10 | +0.10 | +0.10 | +0.10 | +0.10 | +0.10 | +0.10 | +0.10 | +0.05 |
| -0.10 | -0.10 | -0.00 | -0.10 | -0.10 | -0.10 | -0.10 | -0.10 | -0.10 | -0.00 | -0.05 |

Korea Sales Office (KOREA) +82)31-904-1444  
 China Sales Office (CHINA) +86)0758-683-1444  
 Hungary Sales office (EUROPE) +36)1-404-5832

H.K Sales Office (HONGKONG) +852)2711-5551  
 LA Sales Office (USA) +1)714-616-6989

• You can also contact us by e-mail : [coilmaster@coilmaster.com](mailto:coilmaster@coilmaster.com)

- All specifications are subject to change without notice.
- Update date : 2020.09.17

[www.coilmaster.com](http://www.coilmaster.com)