

# CME-NMCB451616A-SERIES

## Features

- ▶ Halogen-Free / RoHS compliant.
- ▶ Small size chips generate high impedance
- ▶ Monolithic structure for high reliability
- ▶ Excellent solderability and high heat resistance for either flow or reflow soldering
- ▶ Low DC resistance structure of electrode prevents wasteful electric power consumption



## Applications

- ▶ Mother board, Tablet PC, Notebook, Desktop computers and peripheral equipment / DSC, DVC, LCD TV, Set top box / Mobile phone, Smart phone, PND / Digital communication equipment / Various automotive electronics / Circuit where a stable ground is unavailable

**Dimension (Unit:mm(inch))**

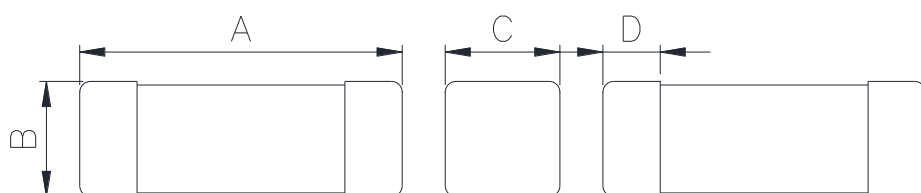

| A       | B       | C       | D       |
|---------|---------|---------|---------|
| 4.5±0.2 | 1.6±0.2 | 1.6±0.2 | 0.6~1.0 |

**Land Pattern (Unit:mm)**

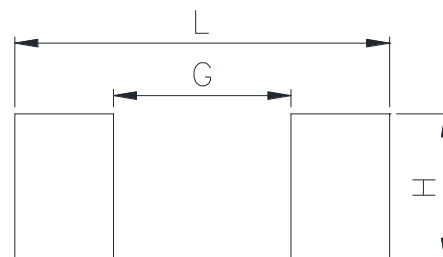

| L    | G    | H    |
|------|------|------|
| 5.70 | 2.70 | 2.24 |

## Regulation of part number

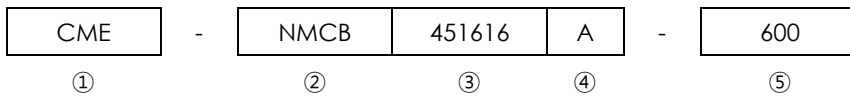

- ① CoilMaster's initial
- ② Product Series Name
- ③ Core Size (unit:mm)
- ④ Material Code
- ⑤ Normal Impedance (600 : 60 ohm)

## Specifications

| Part Number         | Impedance (ohm) $\pm 25\%$ | DCR(ohm) Max. | Rated Current (mA)Max. |
|---------------------|----------------------------|---------------|------------------------|
| CME-NMCB451616A-600 | 60                         | 0.20          | 500                    |
| CME-NMCB451616A-800 | 80                         | 0.30          | 400                    |
| CME-NMCB451616A-101 | 100                        | 0.30          | 400                    |
| CME-NMCB451616A-151 | 150                        | 0.50          | 200                    |
| CME-NMCB451616A-601 | 600                        | 0.80          | 200                    |
|                     |                            |               |                        |
|                     |                            |               |                        |
|                     |                            |               |                        |
|                     |                            |               |                        |
|                     |                            |               |                        |
|                     |                            |               |                        |
|                     |                            |               |                        |
|                     |                            |               |                        |
|                     |                            |               |                        |
|                     |                            |               |                        |
|                     |                            |               |                        |

- Test Condition : 100 MHz, 500 mV
- Rated Current : the DC current value having temperature increased 40 °c after thru DC current 2 hours at ambient temperature.
- Storage Temperature Range : -40 °c ~ +85 °c
- Operating Temperature Range : -55 °c ~ +125 °c

Note 1 : Circuit design, component placement, PCB trace size and thickness, airflow and other cooling. Provision all affect the part Temperature. Part temperature should be verified in the end application.

▪ You can also contact us by e-mail : [coilmaster@coilmaster.com](mailto:coilmaster@coilmaster.com)

- All specifications are subject to change without notice.
- Update date : 2023.03.29

[www.coilmaster.com](http://www.coilmaster.com)

## Electrical characteristics

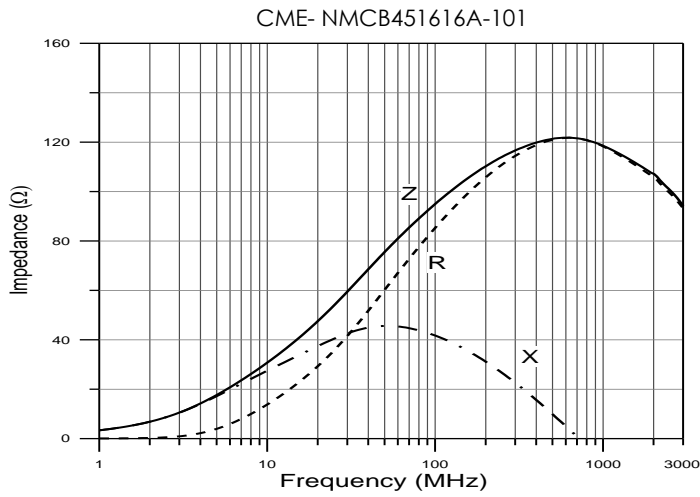
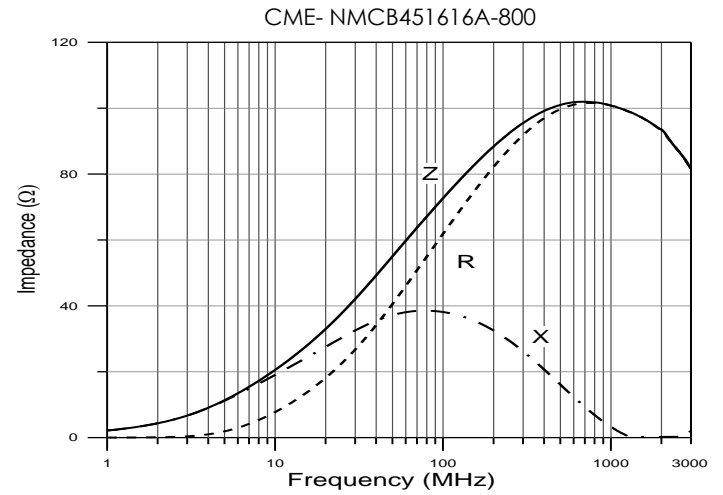
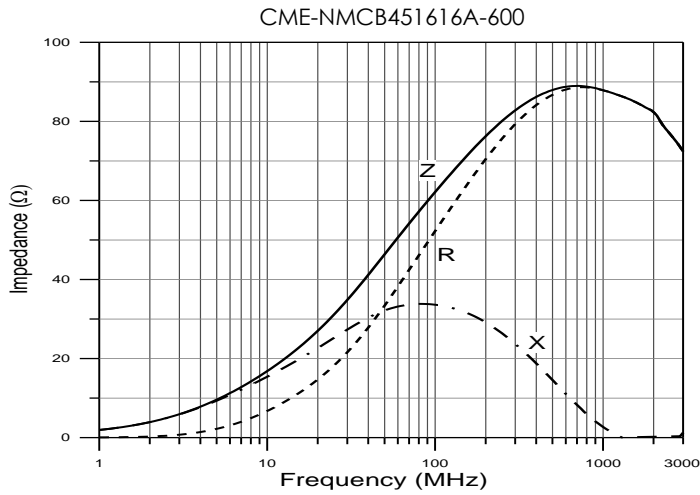

- You can also contact us by e-mail : [coilmaster@coilmaster.com](mailto:coilmaster@coilmaster.com)
- All specifications are subject to change without notice.
- Update date : 2023.03.29

## Packaging

(1) Package quantity : 2,000 (pcs/reel)

(2) Reel Dimensions (unit:mm)

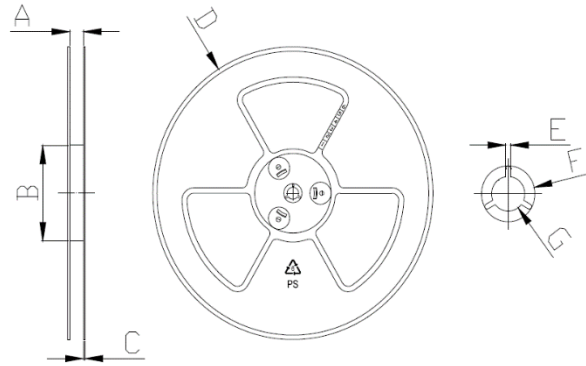

| A     | B     | C     | D     | E     | F     | G     |
|-------|-------|-------|-------|-------|-------|-------|
| 10.00 | 60.00 | 2.00  | 178.0 | 2.00  | 21.00 | 13.00 |
| +1.50 | +2.00 | +0.50 | +2.00 | +0.50 | +0.80 | +0.80 |
| -1.50 | -2.00 | -0.50 | -2.00 | -0.50 | -0.80 | -0.80 |

(3) Tape Dimensions

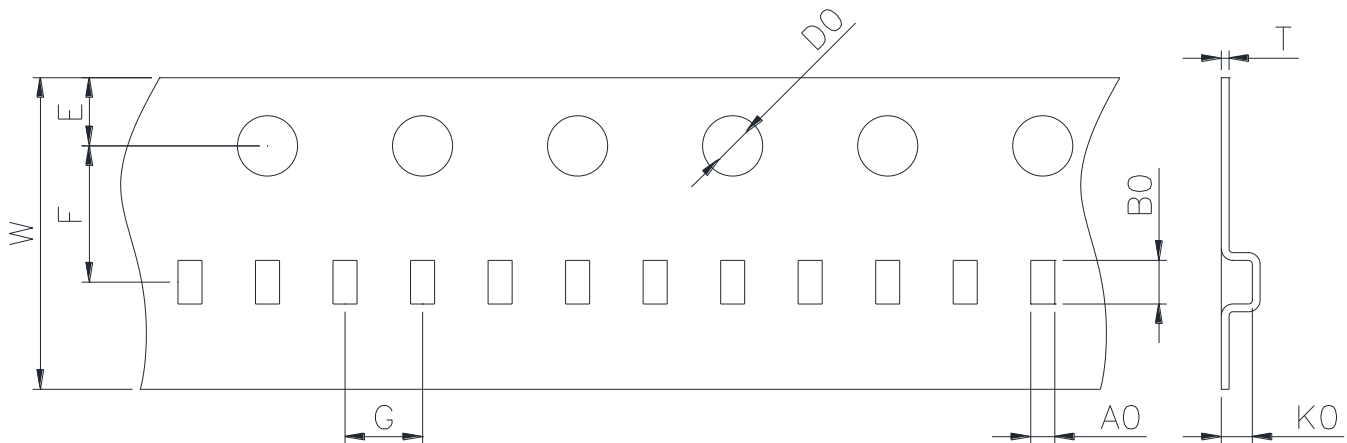

| W     | A0    | B0    | T     | E     | F     | G     | D0    | K0    |
|-------|-------|-------|-------|-------|-------|-------|-------|-------|
| 8.00  | 2.90  | 4.90  | 0.30  | 1.75  | 3.50  | 4.00  | 1.50  | 1.40  |
| +0.20 | +0.10 | +0.10 | +0.05 | +0.10 | +0.05 | +0.10 | +0.10 | +0.05 |
| -0.20 | -0.10 | -0.10 | -0.05 | -0.10 | -0.05 | -0.10 | -0.00 | -0.05 |

Korea Sales Office (KOREA) +82)31-904-1444  
 China Sales Office (CHINA) +86)0758-683-1444  
 Hungary Sales office (EUROPE) +36)1-404-5832

H.K Sales Office (HONGKONG) +852)2711-5551  
 LA Sales Office (USA) +1)714-616-6989

• You can also contact us by e-mail : [coilmaster@coilmaster.com](mailto:coilmaster@coilmaster.com)

- All specifications are subject to change without notice.
- Update date : 2023.03.29

[www.coilmaster.com](http://www.coilmaster.com)