

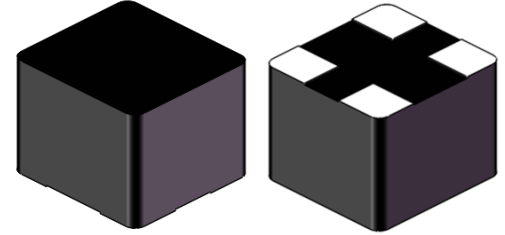

CMI-SMMP10080HL-SERIES

Features

- ▶ High current and low profile
- ▶ Metal powder molding type for EMC protection.
- ▶ Available tape and reel for auto insertion.
- ▶ Coupling Inductor (2in1)
- ▶ Tight winding coupling
- ▶ AEC-Q200 qualified
- ▶ Halogen-Free/ RoHS compliant.



Applications

- ▶ DC/DC Converters in SEPIC topology
- ▶ Flyback, Zeta converters
- ▶ Common mode inductors in power supply lines
- ▶ LED Lighting

Dimension (Unit:mm)

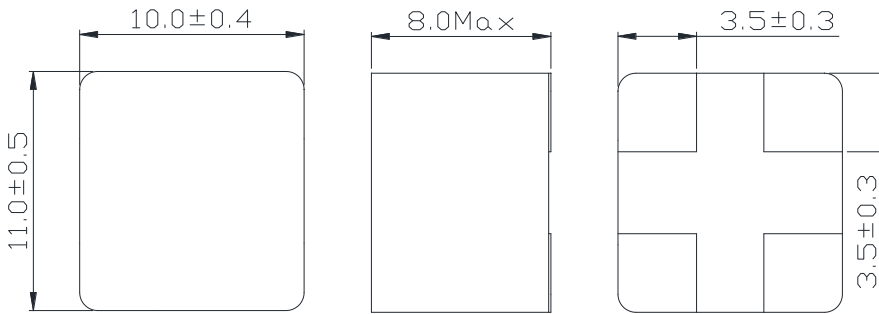

Land Pattern (Unit:mm)

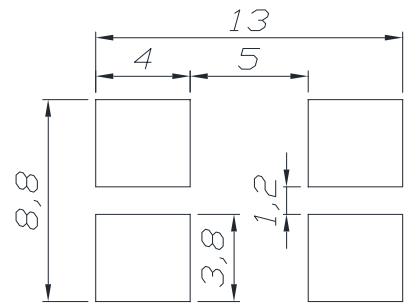

Schemati

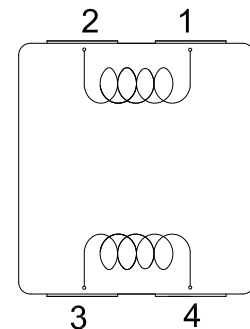

- You can also contact us by e-mail : coilmaster@coilmaster.com
- All specifications are subject to change without notice.
- Update date : 2021.08.23

Electrical characteristics

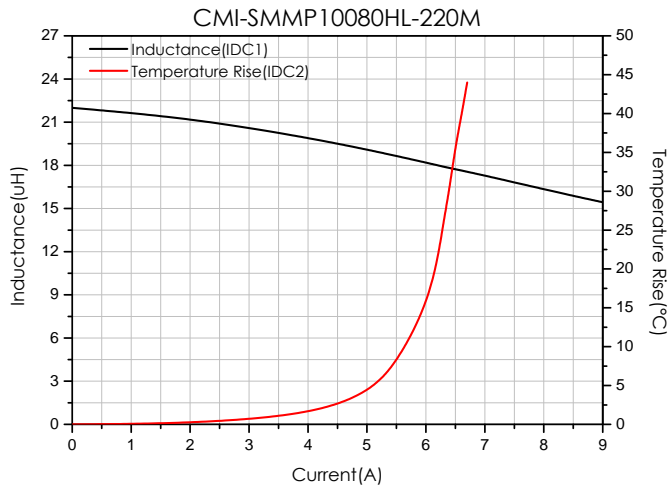
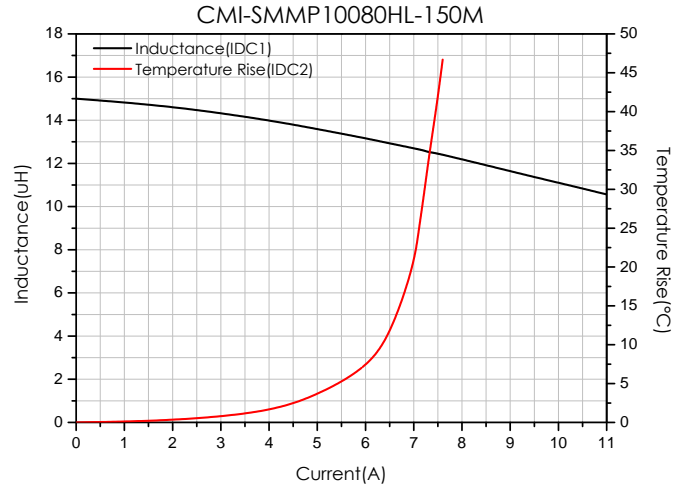
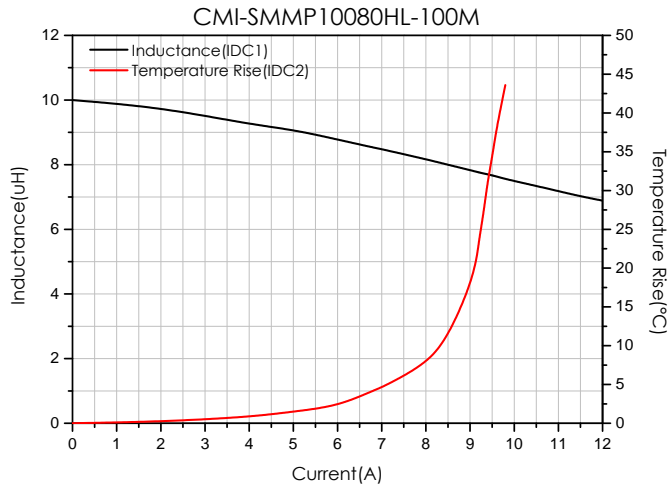

Ilsan Sales Office (KOREA) +82)31-904-1444
 Shenzhen Sales Office (CHINA) +86)755-8663-6929
 Hungary Sales office (EUROPE) +36)30-913-7706

H.K Sales Office (HONGKONG) +852)2711-5551
 LA Sales Office (USA) +1)866-446-3586

- You can also contact us by e-mail : coilmaster@coilmaster.com
- All specifications are subject to change without notice.
- Update date : 2021.08.23